



POWERED BY:
PREMIER
premier.partners

An interpretation of:
Elbphilharmonie, Herzog & De Meuron, HAMBURG (Germany), 2017

STAIR NOSINGS PROFILES

POWERED BY:
PREMIER
premier.partners

PROSTAIR ACC

BRUSHED STAINLESS STEEL AISI 304/1.4301-V2A

STEPS

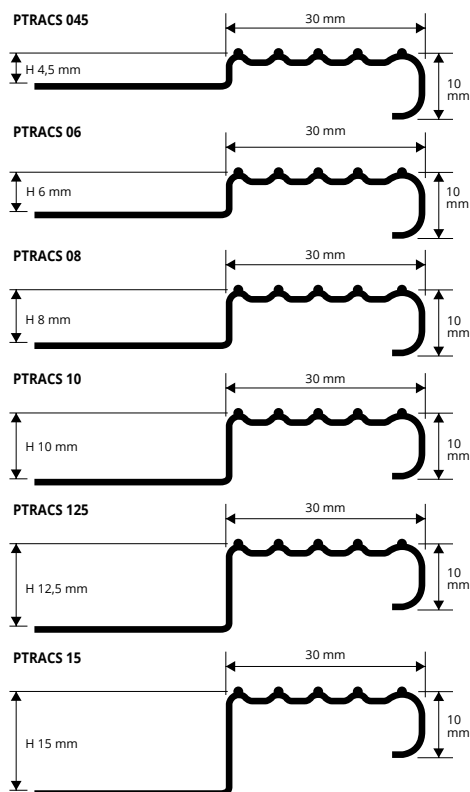

EXAMPLES OF LAYING

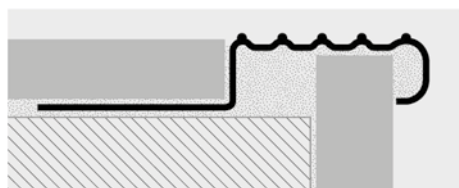

PROSTAIR ACC is steps protecting technical profile, designed and conceived to make the step scales made of ceramic, porcelain stoneware and others nonskid and non-slip ones ; it's to be applied before the step laying process. Manufactured in aisi 304/1.4301-V2A glazed stainless steel, with the superior side level crimped in order to increase its adhesion. It replaces special ceramic elements in refined, resistant and economic way. It is compulsory in public places for the accident prevention. It is recommended for elegant, refined industrial, commercial and private environments: available in H 4,5-6-8-10-12,5-15 mm versions. Combining with the entire series of steel profiles recommended.



BRUSHED STAINLESS ST. AISI 304/1.4301-V2A with protective film
bar length 2,7 lm - pack. 15 Pcs - 40,5 lm - 10/10 mm

Article	H mm	€/lm	€/Pc
PTRACS 045	4,5	16,60	44,82
PTRACS 06	6	17,09	46,14
PTRACS 08	8	17,49	47,22
PTRACS 10	10	18,01	48,63
PTRACS 125	12,5	18,65	50,35
PTRACS 15	15	19,54	52,76

Available in Brushed STAINLESS STEEL AISI 316L/1.440-V4A (minimum quantity order 100 pcs - price to be agreed. Production delay 4/5 weeks).

OUT OF STANDARD SIZE PRICES:

For Length 1 lm + 10% (minimum order of 100 pcs)
For Length 1,5 lm + 5% (minimum order of 100 pcs)

LAYING INSTRUCTIONS

1. Choose the PROSTAR ACC of the desired height and material on the basis of the tile (steps) thickness. 2. Fix the first rising part laying it down at its appropriate and definitive level. 3. Fill completely the empty spaces under the profile with the tile adhesive. 4. Spread out the adhesive on the tread, lay down the profile with its cut base immersed completely in adhesive and align it so that the profile covers the riser tile edge. 5. Lay down the tread tiles and align them with the superior grazing part of the profile by drawing its back close and filling the inner space with the adhesive.

END CAP IN VARNISHED PLASTIC BRUSHED STAINLESS STEEL EFFECT
pack. 2 Pcs (1 right and 1 left)

Article	H mm	€/Pack.
TPTRACS/1	4,5 ÷ 15	3,12

Articles not for sale singly

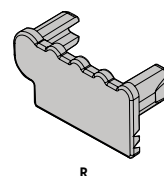
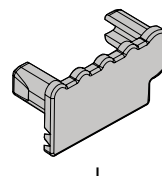

COLOURS

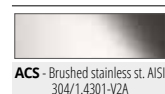

SUITABLE FOR USE IN CONTACT WITH FOODSTUFFS

PROSTYLE 2610

BRUSHED STAINLESS STEEL AISI 304/1.4301-V2A
SELF ADHESIVE OR PUNCHED

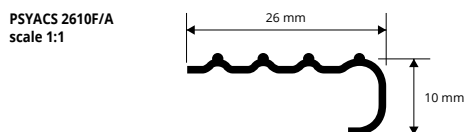

EXAMPLES AND INSTRUCTIONS FOR LAYING METHODS

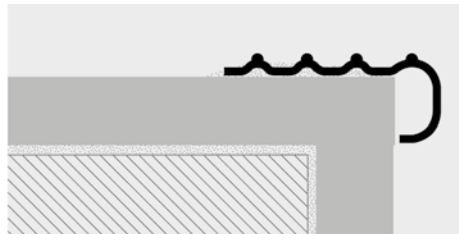

Adhesive version

1. Choose the suitable profile and cut it to the necessary length. 2. Degrease, wash and clean the solid surface thoroughly. 3. Remove the protective paper from the adhesive. 4. Lay the profile by applying pressure evenly over the whole surface without using a hammer.

Punched version

1. Choose the suitable profile and cut it to the necessary length. 2. Mark the position of the holes using the existing holes in the profile as reference. 3. Insert the screw anchors into the drilled holes. 4. Fix the profile using flathead screws suitable for the relative slots in the profile.

PROSTYLE 2610 is steps protecting technical profile, designed and conceived to keep the step scales made of ceramic, porcelain stoneware, wood, marble and others nonskid and non-slip ones ; it's to be applied after the step laying process or in the already present rooms. Manufactured in aisi 304/1.4301-V2A glazed stainless steel, with the superior side level crimped in order to increase its adhesion. It replaces special ceramic elements in refined, resistant and economic way. It's ideal for the edges protection and screening as well as of the corner between the rising and the tread which is the point of the greatest strain. It is compulsory in public places for the accident prevention. It is recommended for elegant, refined industrial, commercial and private environments. Available in drilled version or in with adhesive one.

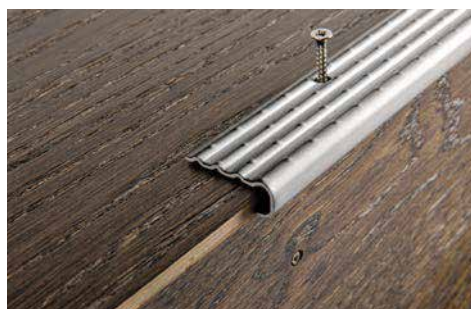

BRUSHED STAINLESS STEEL AISI 304/1.4301-V2A PUNCHED with protective film - bar length 2,7 lm - pack. 20 Pcs - 54 lm - 10/10mm

Article	H mm	€/lm	€/Pc
PSYACS 2610F	10	14,00	37,80 *

Available in Brushed STAINLESS STEEL AISI 316L/1.440-V4A (minimum quantity order 100 pcs - price to be agreed. Production delay 4/5 weeks).

OUT OF STANDARD SIZE PRICES:

For Length 1 lm + 10% (minimum order of 100 pcs)
For Length 1,5 lm + 5% (minimum order of 100 pcs)

BRUSHED STAINLESS STEEL AISI 304/1.4301-V2A WITH ADHESIVE with protective film - bar length 2,7 lm - pack. 20 Pcs - 54 lm - 10/10mm

Article	H mm	€/lm	€/Pc
PSYACS 2610A	10	16,54	44,66 *

COLOURS

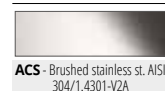

SUITABLE FOR USE IN CONTACT WITH FOODSTUFFS

* = Production on demand with minimum quantity of 100 pcs. Production delay 4/5 weeks. Price to be agreed

Prices are referred to whole packs, 10% increase for minimum orders of 10 pcs, 20% increase for orders of less than 10 pcs.

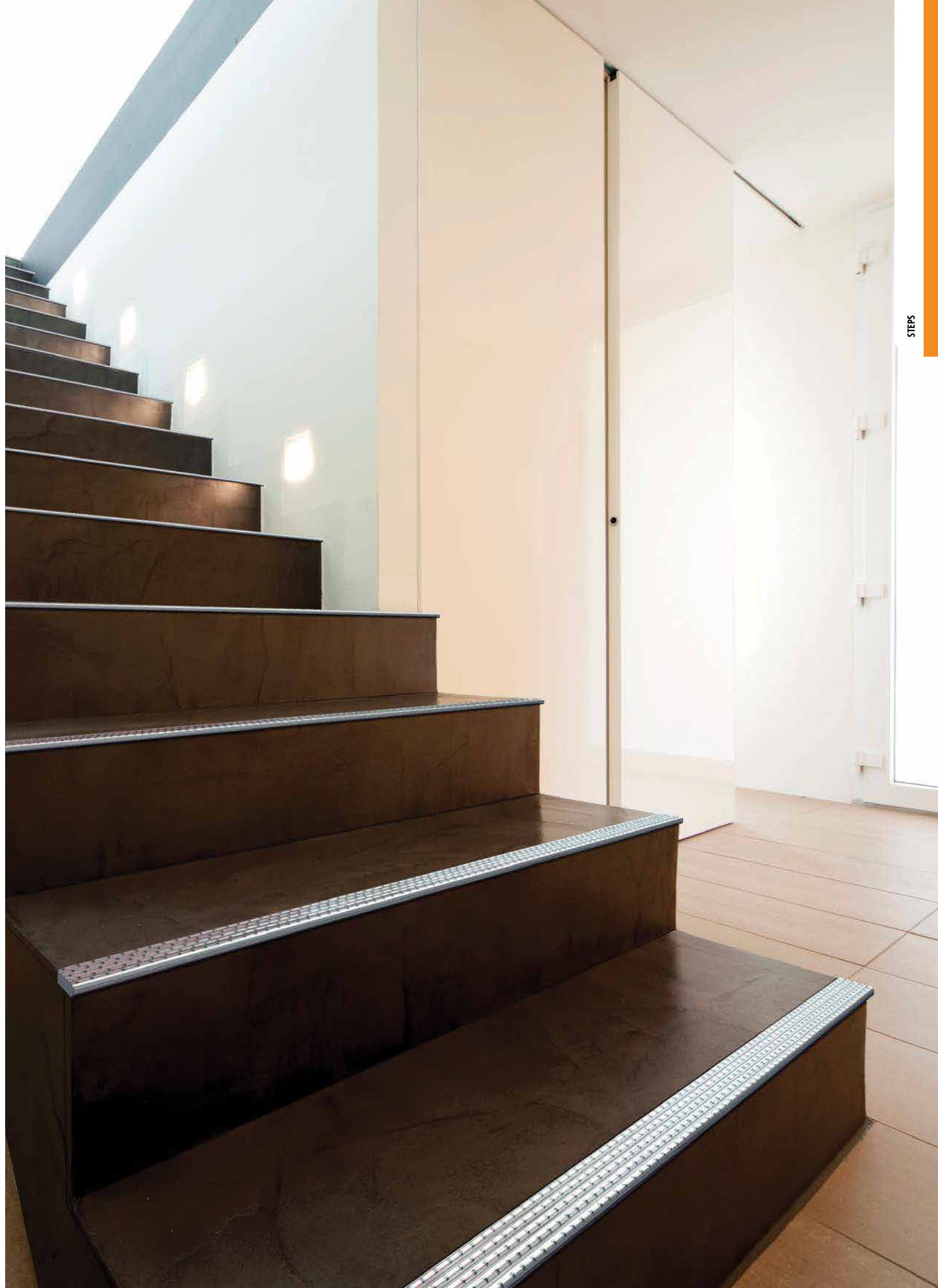



PROSTAIR GRIP ACC is an AISI 304/1.4301-V2A brushed stainless steel profile, consisting of a punched flange, ensuring perfect anchorage to the substrate, a 36,5 and 56,5 mm horizontal visually exposed surface with the carborundum stripe insert and a 20 mm vertical visually exposed flat surface. The profile is available in the heights 4,5/6/8/10/12,5/15/20 mm and is equipped with end caps made of varnished plastic in brushed steel-effect finish. The design of this profile together with the completing elements make it an elegant and appreciated solution also for modern stairs.

PROSTAIR GRIP ACC

BRUSHED STAINLESS STEEL AISI 304/1.4301-V2A

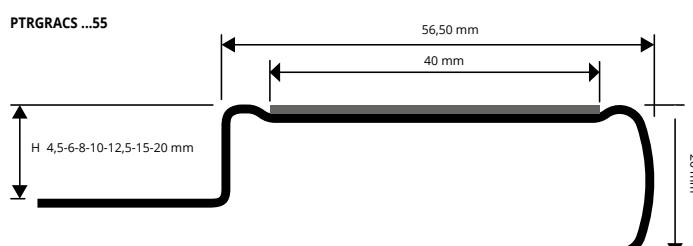
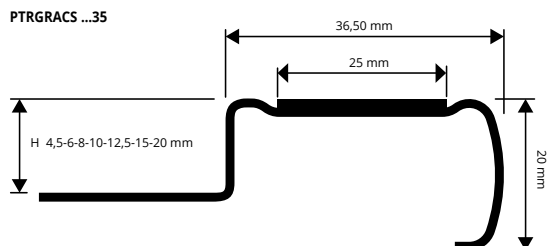

BRUSHED STAINLESS STEEL AISI 304/1.4301-V2A
with protective film - bar length 2,7 lm - width 36,50 mm

Article	H mm	Pcs/Pack	€/lm	€/Pc
PTRGRACS 04535	4,5	20	32,96	88,99
PTRGRACS 0635	6	20	33,40	90,18
PTRGRACS 0835	8	20	33,71	91,02
PTRGRACS 1035	10	10	35,45	95,72
PTRGRACS 12535	12,5	10	37,50	101,25
PTRGRACS 1535	15	7	39,62	106,97
PTRGRACS 2035	20	7	43,41	117,21

BRUSHED STAINLESS STEEL AISI 304/1.4301-V2A
with protective film - bar length 2,7 lm - width 56,50 mm

Article	H mm	Pcs/Pack	€/lm	€/Pc
PTRGRACS 04555	4,5	20	39,48	106,60
PTRGRACS 0655	6	20	40,43	109,16
PTRGRACS 0855	8	20	41,36	111,67
PTRGRACS 1055	10	10	42,91	115,86
PTRGRACS 12555	12,5	10	45,40	122,58
PTRGRACS 1555	15	7	47,26	127,60
PTRGRACS 2055	20	7	50,99	137,67

THE ADHESIVE CARBORUNDUM STRIP (PROGRIP) IS NOT INCLUDED WITH THE PROFILE.

FOR PTRGRACS ...35 ORDER PGR... 25 (SPECIFY THE CHOSEN COLOUR).

FOR PTRGRACS ...55 ORDER PGR... 40 (SPECIFY THE CHOSEN COLOUR).

COLOURS

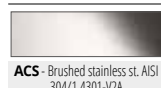

END CAPS - R/L - pack. 2 Pcs (1 R and 1 L)

Article	H mm	L mm	€/Pack.
TPTGRACS 55/1	4,5+20	56,5	2,97
TPTGRACS 35/1	4,5+20	36,5	2,97

Articles not for sale singly

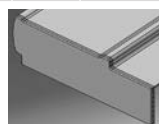

SUITABLE FOR USE IN CONTACT WITH FOODSTUFFS

EXAMPLES AND INSTRUCTIONS FOR LAYING METHODS

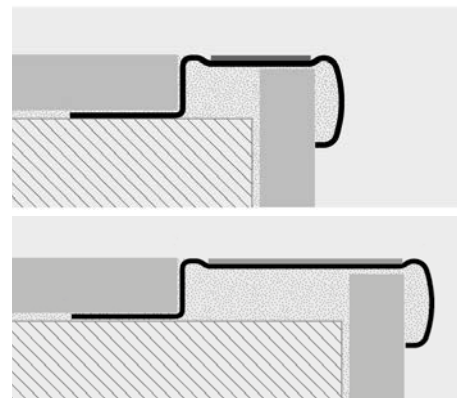

1. Choose the PROSTAIR GRIP ACC in the required height, according to the thickness of the floor covering and the desired profile width;
2. Lay the floor covering on the stair riser and apply the adhesive on the of stair tread, where the profile will be installed;
3. Fill the empty spaces under the profile with the adhesive for tiles. Lay the profile on the step tread, making sure that it is aligned with the stair riser;
4. Lay the floor covering on the stair tread and align;
5. Plaster the joints between the profile and the tiles.

PROGRIP is a carborundum adhesive stripe, consisting of an elastic film coated with high wear resistant abrasive grains. It is usually employed in public as well as in domestic environments to make stair steps non-slip. The stripe is available in different colors and widths to meet any technical and aesthetic requirement. If **PROGRIP** is applied directly on the step covering, it is advisable to apply two stripes on each step, rounding their ends.

PROGRIP

ADHESIVE CARBORUNDUM - 7 COLOURS

COLOURS

N - Black	B - White	T - Transparent
G - Gray	Y - Yellow	M - Brown
GN - Yellow/Black	The PGRT (transparent) are not suitable for outside use.	

ADHESIVE NON-SLIP STRIP for STEPS - rolls length 18,2 lm

Article	Width mm	€/lm	€/Roll
PGRGN 20	20	1,93	35,13
PGRGN 25	25	2,59	47,14
PGRGN 50	50	5,31	96,64

ADHESIVE NON-SLIP STRIP for STEPS - rolls length 18,2 lm

Article	Width mm	€/lm	€/Roll
PGRN 25	25	2,55	46,41
PGRB 25	25	3,83	69,71
PGRT 25	25	2,55	46,41
PGRG 25	25	4,34	78,99
PGRY 25	25	4,21	76,62
PGRM 25	25	2,93	53,33
PGRN 40	40	3,83	69,71
PGRB 40	40	6,78	123,40
PGRT 40	40	3,83	69,71
PGRG 40	40	7,63	138,87
PGRY 40	40	7,63	138,87
PGRM 40	40	4,43	80,63



* = Production on demand with minimum quantity of 10 rolls. Production delay 4/5 weeks. Price to be agreed

News 2021

Prices are referred to whole packs, 10% increase for minimum orders of 10 pcs, 20% increase for orders of less than 10 pcs.

PROSTYLE GRIP ACC

BRUSHED STAINLESS STEEL
AISI 304/1.4301-V2A

PROSTYLE GRIP ACC is a non-slip profile in AISI 304/1.4301-V2A brushed stainless steel, consisting of a 40 or 60 mm horizontal top with a groove for the insertion of a non-slip carborundum stripe and a 20mm vertical flat side. The profile can be fixed with adhesive film or with screws. The particular design of this profile makes it an elegant and appreciated solution also for modern stairs.

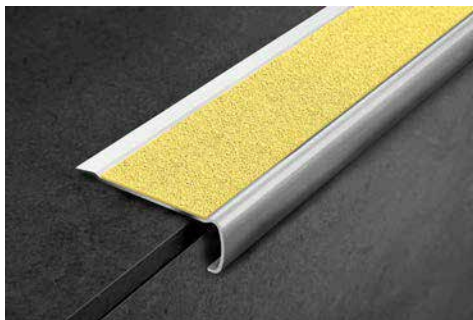

PSYGRACS 6020
scale 1:1

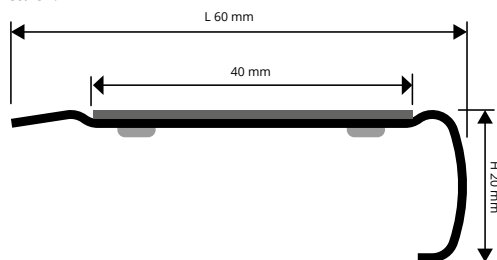

PSYGRACS 4020
scale 1:1

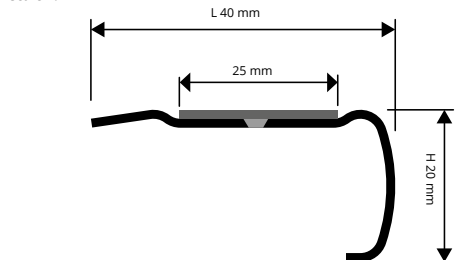

EXAMPLES AND INSTRUCTIONS FOR LAYING METHODS

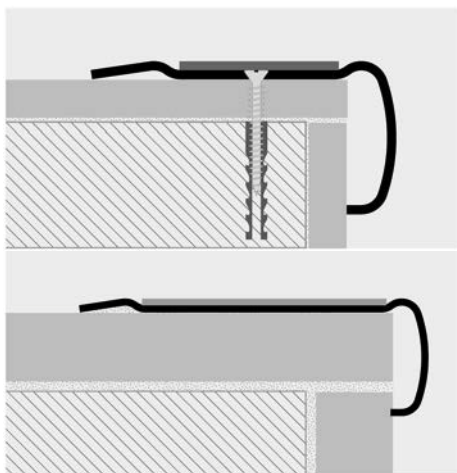

Version with adhesive

1. Choose the profile according to the desired width and cut it to the necessary length; 2. Clean the surface on which the profile is to be laid, ensuring that it is dry. Remove the protective film and place the profile, applying adequate pressure on it; 3. Apply the adhesive non-slip carborundum insert of the desired color.

Punched version

1. Choose the profile according to the desired width and cut it to the necessary length; 2. Mark the position of the holes using the existing holes on the profile as reference; 3. Drill the step using a drill with 5mm diameter and insert the 5x25mm screws; 4. Screw the profile to the step; 5. Apply the adhesive non-slip carborundum insert of the desired color.

BRUSHED STAINLESS STEEL AISI 304/1.4301-V2A with protective film
bar length 2,7 lm - pack. 20 Pcs - 54 lm

Article	L mm	€/lm	€/Pc
PSYGRACS 6020A	60	35,95	97,07 *
PSYGRACS 6020F	60	34,32	92,66 *

Without adhesive version deduct 3,00 €/LM to the gross price

The adhesive carborundum strip (PROGRIP) is not included with the profile.

For PSYGRACS 6020A/F order PGR... 40 (Specify the chosen colour).

For PSYGRACS 4020A/F order PGR... 25 (Specify the chosen colour).

BRUSHED STAINLESS STEEL AISI 304/1.4301-V2A with protective film
bar length 2,7 lm - pack. 20 Pcs - 54 lm

Article	L mm	€/lm	€/Pc
PSYGRACS 4020A	40	30,48	82,30
PSYGRACS 4020F	40	28,60	77,22

Without adhesive version deduct 3,00 €/LM to the gross price

COLOURS

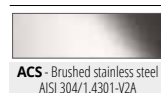

END CAPS STAINLESS STEEL - R/L - pack. 2 Pcs - (1 R and 1 L)

Article	L mm	€/Pack.
TPSYGRACS 6020/1	60	3,12 *
TPSYGRACS 4020/1	40	3,12

Articles not for sale singly

SUITABLE FOR USE IN CONTACT WITH FOODSTUFFS

* = Production on demand with minimum quantity of 100 pcs. Production delay 4/5 weeks. Price to be agreed

PROGRIP

ADHESIVE CARBORUNDUM - 7 COLOURS

ADHESIVE CARBORUNDUM NON-SLIP STRIP for STEPS

rolls length 18,2 lm

Article	Width mm	€/lm	€/Roll
PGRN 25	25	2,55	46,41
PGRB 25	25	3,83	69,71
PGRT 25	25	2,55	46,41
PGRG 25	25	4,34	78,99
PGRY 25	25	4,21	76,62
PGRM 25	25	2,93	53,33
PGRN 40	40	3,83	69,71
PGRB 40	40	6,78	123,40
PGRT 40	40	3,83	69,71
PGRG 40	40	7,63	138,87 *
PGRY 40	40	7,63	138,87 *
PGRM 40	40	4,43	80,63

COLOURS

N - Black	B - White	T - Transparent
G - Gray	Y - Yellow	M - Brown
GN - Yellow/Black	The PGRT (transparent) are not suitable for outside use.	

ADHESIVE NON-SLIP STRIP for STEPS - rolls length 18,2 lm

Article	Width mm	€/lm	€/Roll
PGRGN 20	20	1,93	35,13
PGRGN 25	25	2,59	47,14
PGRGN 50	50	5,31	96,64

* = Production on demand with minimum quantity of 10 rolls. Production delay 4/5 weeks. Price to be agreed

News 2021

Prices are referred to whole packs, 10% increase for minimum orders of 10 pcs, 20% increase for orders of less than 10 pcs.

PROSTAIR 50 is a technical square used to make the step nonskid and non-slip, protects the ceramic stairs steps preventing from accidents. It is made up of a rigid aluminium base equipped with a particular toothing on the vertical stem which strengthens the anchorage of the adhesive/tile to the square. The aluminium base varies according to the thickness of the tile used in the step, and to a lined insert in vinyl rubber available in several colors. The insert is already applied to the aluminium base. It is compulsory in public places in compliance with EEC norms and prevents from accidents.

PROSTAIR 50

NATURAL ALUMINIUM
+ VINYL RESIN / RUBBER INSERT



NATURAL ALUMINIUM + VINYL RESIN / RUBBER INSERT
bar length 2,7 lm - pack. 20 Pcs - 54 lm

Article	H mm	€/lm	€/Pc
PTR50 08...	8	20,42	55,13
PTR50 10...	10	21,25	57,38
PTR50 125...	12,5	21,90	59,13
PTR50 15...	15	23,03	62,18

Available in the colours: G - N - B - A.
The code of the selected colour must be added to the article code.
E.g.: PTR50 08... (chosen colour grey) PTR50 08G.

COLOURS

G - Gray (E83)	N - Black (E85)	B - Beige (E84)
A - Ivory (E81)		

END CAP IN PVC - pack. 2 Pcs (1 R and 1 L)

Article	H mm	€/Pack.
TPTR50 .../1	8-10-12,5-15	3,12

Available in the colours: G - N - B - A.
The code of the selected colour must be added to the article code.
E.g.: TPTR50 ... (chosen colour grey) TPTR50 G.
Articles not for sale singly

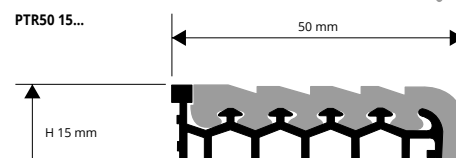
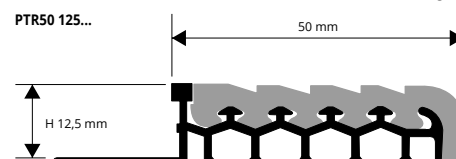
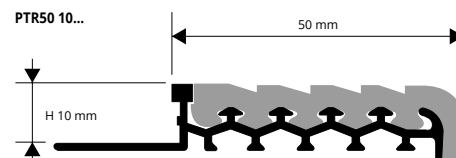
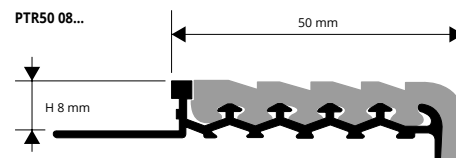
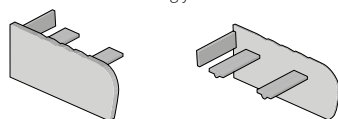

EXAMPLES AND INSTRUCTIONS FOR LAYING METHODS

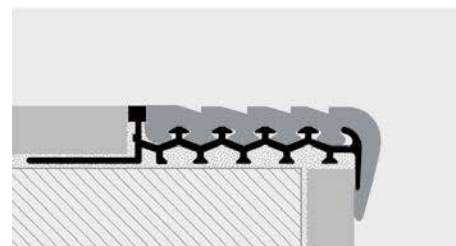

1. Choose a PROSTAIR 50 height and color corresponding to the thickness of the tile. 2. Fix the riser laying it at the appropriate and definitive height. 3. Fill the empty spaces under the square completely with adhesive. 4. Rest the adhesive on the tread, lay the square with the base cut in the adhesive and line it up so that the square covers the tile edge of the riser. 5. Lay the tiles of the tread lining them up with upper part of the square so that it meets with the edge.

INTERCHANGEABLE INSERT for Prostair 50

VINYL RESIN / RUBBER

INTERCHANGEABLE VINYL RESIN / RUBBER INSERT
bar length 2,7 lm - pack. 20 Pcs - 54 lm

Article	H mm	€/lm	€/Pc
PTG50...	8-10-12,5-15	7,09	19,14

Universal insert suitable for four profile heights.
Available in the colours: G - N - B - A.
The code of the selected colour must be added to the article code.
E.g.: PTG50... (chosen colour grey) PTG50 G.



PROSTAIR

NATURAL ALUMINIUM
+ VINYL RESIN / RUBBER INSERT

PROSTAIR is a step nosing profile used to improve slip and slide resistance on the step, to protect ceramic steps and to prevent accidents. It consists of a rigid aluminium base and a changeable vinyl rubber insert available in various colours and widths. Compulsory in public environments to comply with EEC accident-prevention standards.

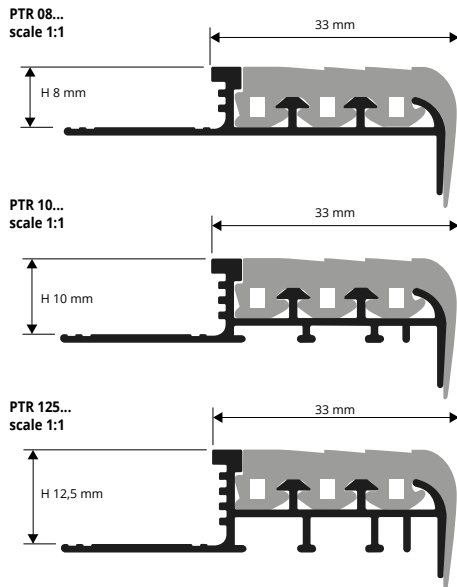

EXAMPLES AND INSTRUCTIONS FOR LAYING METHODS

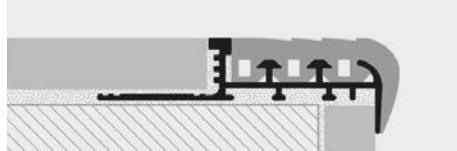

1. Choose the PROSTEP/PROSTAIR in the required width and colour according to the thickness of the tile. 2. First fix the riser part, placing it at the correct and final height. 3. Fill the empty spaces under the profile with the tile adhesive. 4. Apply the adhesive to the tread, lay the profile with the punched base fully sunk into the adhesive and align the profile so that its lip covers the edge of the riser tile. 5. Lay the tread tiles, aligning them so that they are flush with the upper and rear part of the profile.



INTERCHANGEABLE VINYL RESIN / RUBBER INSERT

bar length 2,7 lm - pack. 20 Pcs - 54 lm

Article	€/ml	€/Pack.
PTGRA	4,37	11,80
PTGRB	4,37	11,80
PTGRN	4,37	11,80
PTGRG	4,37	11,80

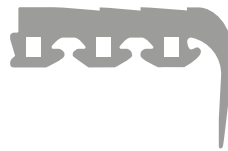

COLOURS

G - Gray (E83)	N - Black (E85)	B - Beige (E84)
A - Ivory (E81)		

NATURAL ALUMINIUM + VINYL RESIN / RUBBER INSERT

bar length 2,7 lm - pack. 10 Pcs - 27 lm

Article	H mm	€/ml	€/Pack.
PTR 08...	8	12,83	34,64
PTR 10...	10	13,85	37,40
PTR 125...	12,5	14,31	38,64

Available in the colours: G - N - B - A. The code of the selected colour must be added to the article code.
E.g.: PTR 08... (chosen colour grey) PTR 08G.

END CAP IN PVC - pack. 2 Pcs (1 R and 1 L)

Article	H mm	€/Pack.
TPT 08.../1	8	3,12
TPT 10.../1	10	3,12
TPT 125.../1	12,5	3,12

Available in the colours: G - N - B - A.
The code of the selected colour must be added to the article code.
E.g.: TPT 08... (chosen colour grey) TPT 08G.
Articles not for sale singly

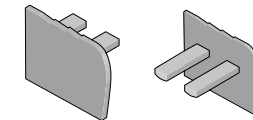

PROSTEP

RIGID VINYL RESIN
+ VINYL RESIN / RUBBER INSERT

PROSTEP is a step nosing profile used to improve slip and slide resistance on the step, to protect ceramic steps and to prevent accidents. It consists of a rigid base in high-strength vinyl resin and a changeable vinyl rubber insert available in various colours and widths. Compulsory in public environments to comply with EEC accident-prevention standards.

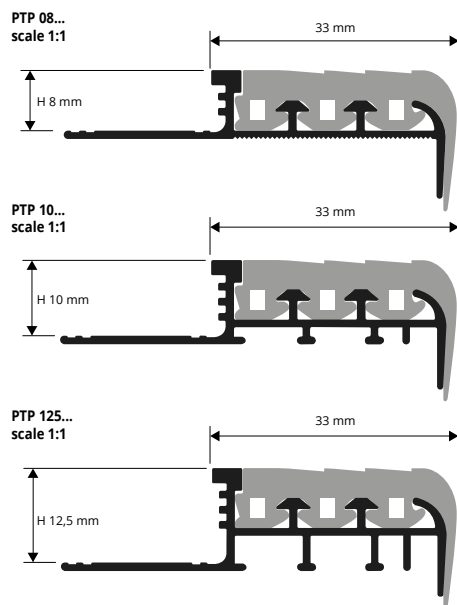

For instructions see the product above



INTERCHANGEABLE VINYL RESIN / RUBBER INSERT

bar length 2,7 lm - pack. 20 Pcs - 54 lm

Article	€/lm	€/Pc
PTGRA	4,37	11,80
PTGRB	4,37	11,80
PTGRN	4,37	11,80
PTGRG	4,37	11,80

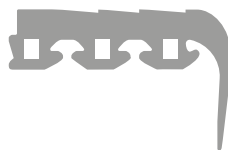

COLOURS

G - Gray (E83)	N - Black (E85)	B - Beige (E84)	A - Ivory (E81)
----------------	-----------------	-----------------	-----------------

IMPACT PROOF VINYL RESIN + VINYL RESIN / RUBBER INSERT

bar length 2,7 lm - pack. 10 Pcs - 27 lm (PTP 08... - 54 lm)

Article	H mm	€/lm	€/Pc
PTP 08...	8	6,42	17,33
PTP 10...	10	7,09	19,14
PTP 125...	12,5	7,71	20,82

Available in the colours: G - N - B - A. The code of the selected colour must be added to the article code.
E.g.: PTP 08... (chosen colour grey) PTP 08G.

END CAP IN PVC - pack. 2 Pcs (1 R and 1 L)

Article	H mm	€/Pack.
TPT 08.../1	8	3,12
TPT 10.../1	10	3,12
TPT 125.../1	12,5	3,12

Available in the colours: G - N - B - A.
The code of the selected colour must be added to the article code.
E.g.: TPT 08... (chosen colour grey) TPT 08G.
Articles not for sale singly

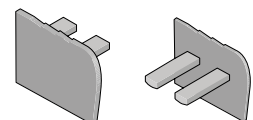

PROBRASTEP is a very elegant step nosing profile used to improve slip and slide resistance on the step. Made in natural and polished brass or natural and anodized silver aluminium, the upper part is knurled to increase adherence. Compulsory in public buildings to comply with accident-prevention regulations. Recommended for elegant, refined surroundings and for steps in wood, tiles, melamine-coated/laminated wood, marble or natural stones. Width: 8, 10, 12.5 mm.

PROBRASTEP

KNURLED NATURAL AND POLISHED BRASS
NATURAL AND ANODIZED SILVER ALUMINIUM



NATURAL BRASS thermo packed 5 Pcs
bar length 2,7 lm - pack. 20 Pcs - 54 lm

Article	H mm	€/lm	€/Pc
PBPON 10	10	24,63	66,50
PBPON 125	12,5	26,05	70,34

POLISHED BRASS thermo packed
bar length 2,7 lm - pack. 20 Pcs - 54 lm

Article	H mm	€/lm	€/Pc
PBPOL 10	10	28,01	75,63
PBPOL 125	12,5	29,40	79,38

NATURAL ALUMINIUM thermo packed 5 Pcs
bar length 2,7 lm - pack. 20 Pcs - 54 lm

Article	H mm	€/lm	€/Pc
PBPAN 08	8	6,13	16,55
PBPAN 10	10	6,46	17,44
PBPAN 125	12,5	6,91	18,66

ANODIZED SILVER ALUMINIUM thermo packed
bar length 2,7 lm - pack. 20 Pcs - 54 lm

Article	H mm	€/lm	€/Pc
PBPAA 08	8	7,79	21,03
PBPAA 10	10	8,12	21,92
PBPAA 125	12,5	8,56	23,11

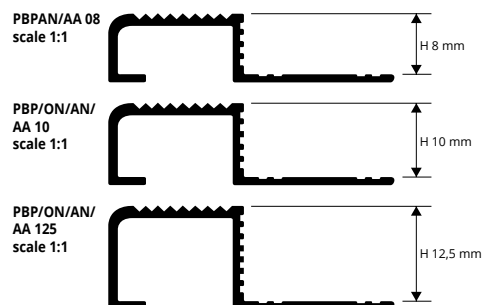

EXAMPLES AND INSTRUCTIONS FOR LAYING METHODS

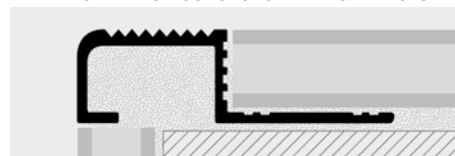

1. Choose the PROBRASTEP in the required width and colour according to the thickness of the tile (stairs). 2. First fix the riser part, placing it at the correct and final height. 3. Fill the empty spaces under the profile with the tile adhesive. 4. Apply the adhesive to the tread, lay the profile with the punched base fully sunk into the adhesive and align the profile so that its lip covers the edge of the riser tile. 5. Lay the tread tiles, aligning them so that they are flush with the upper and rear part of the profile and filling the internal part with adhesive. Oxidation marks in the polished/natural brass range may be easily removed with specific chemical products (Sidel-Smac).

COLOURS



PROSTAIR BOTTOM / STRIP are a tactile anti-slip bottom/strip made in stainless steel AISI 316/1.4401-V4A. **PROSTAIR BOTTOM / STRIP** has the function to realize the signaling lanes to the floor, and warning stairs, able to guide the blind and visually impaired. It is available with a length of 28.5 cm, a width of 3.5 cm and a thickness of 5mm and is provided with 3 stems, 2 cm high, for its fastening.

PROSTAIR BOTTOM / STRIP

POLISHED, BRUSHED STAINLESS STEEL AISI 316/1.4404-V4A



PROSTAIR BOTTOM
POLISHED STAINLESS STEEL AISI 316/1.4404-V4A - pack. 20 Pcs

Article	Ø mm	€/Pc	€/pack
PTRB 3520/20	35		123,17

PROSTAIR BOTTOM STRIP
BRUSHED STAINLESS STEEL AISI 316/1.4404-V4A - pack. 10 Pcs

Article	L x H mm	€/Pc	€/pack
PTRB 28035/10	280 X 35		360,08

INSTRUCTIONS FOR LAYING METHODS

1. Put PROSTAIR BOTTOM TEMPLATE on the desired zone. 2. Score on the support the position of the necessary holes. 3. Remove the template and drill the substrate with a tip 4 mm for a depth of approximately 2.5 cm. 4. Open the holes already made with a 8mm drill bit. 5. Remove dust residues. 6. Fill the hole with PROBAND FIX. 7. Put in the hole PROSTAIR BOTTOM.

INSTRUCTIONS FOR LAYING METHODS

1. Put PROSTAIR BOTTOM STRIP on the desired zone. 2. Scoring on the support in correspondence of the stems the points at which pierce. 3. Drill the substrate with a tip 4 mm for a depth of approximately 2.5 cm. 4. Open the holes already made with a 8mm drill bit. 5. Remove dust residues. 6. Fill the hole with PROBAND FIX. 7. Put in the hole PROSTAIR BOTTOM STRIP.

PTRB 3520

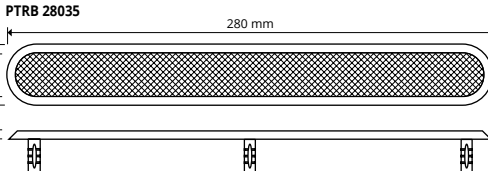
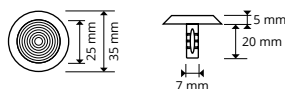

PROSTAIR BOTTOM TEMPLATE for PROSTAIR BOTTOM

ZINC-PLATED STEEL

PROSTAIR BOTTOM TEMPLATE is a mold, made in zinc-plated steel, which allows to score the points where to drilling for the mounting of PROSTAIR BOTTOM. **PROSTAIR BOTTOM TEMPLATE** has a size of 30 x 44.5 cm and is equipped with 48 holes of a diameter 4 mm. Provided with circular joints which can be connected to other molds.

ZINC-PLATED STEEL

pack. 4 Pcs

Article	L x H mm	€/Pc	€/pack
PTRTEM/4	445 x 300		743,77

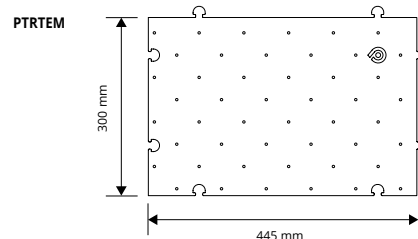

* = Production on demand with minimum quantity of 100 pcs. Production delay 4/5 weeks. Price to be agreed

Prices are referred to whole packs, 10% increase for minimum orders of 10 pcs, 20% increase for orders of less than 10 pcs.

PROTERMSTEP ACC

POLISHED, BRUSHED STAINLESS
STEEL AISI 304/1.4301-V2A

PROTERMSTEP ACC is the new step cover profile made of stainless steel. Designed to protect the edge of the step and to hide the joint between the tread and the step rise. The special notched shape in the upright stem provides it with excellent anchorage between floor/glue/profile. Reversible profile.

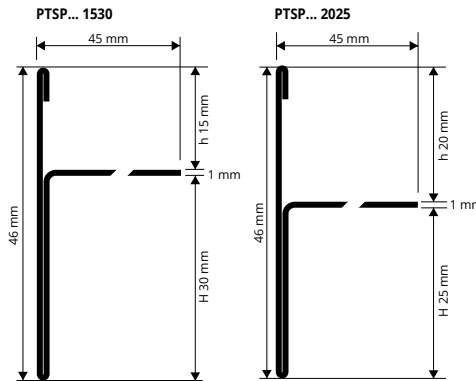
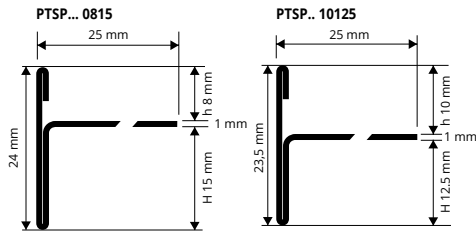

EXAMPLES OF LAYING for instructions see the product below



POLISHED STAINLESS STEEL AISI 304/1.4301-V2A with protective film
bar length 2,7 lm - pack. 15 Pcs - 40,5 lm

Article	h / H mm	€/lm	€/Pc
PTSPAC 0815	08 / 15	17,88	48,28
PTSPAC 10125	10 / 12,5	17,88	48,28
PTSPAC 1530	15 / 30	34,23	92,42
PTSPAC 2025	20 / 25	34,23	92,42

EXTERNAL CORNERS - pack. 10 Pcs

Article	h / H mm	€/Pack.
REPTSAC 0815/10	08 / 15	418,28
REPTSAC 10125/10	10 / 12,5	418,28
REPTSAC 1530/10	15 / 30	418,28
REPTSAC 2025/10	20 / 25	418,28

JUNCTION H 10 - 12,5 - 15 - 20 mm - pack. 10 Pcs

Article	h / H mm	€/Pack.
GIPTSAC 0815/10	08 / 15	76,56
GIPTSAC 10125/10	10 / 12,5	76,56
GIPTSAC 1530/10	15 / 30	76,56
GIPTSAC 2025/10	20 / 25	76,56



BRUSHED STAINLESS ST. AISI 304/1.4301-V2A
bar length 2,7 lm - pack. 15 Pcs - 40,5 lm

Article	h / H mm	€/lm	€/Pc
PTSPACS 0815	08 / 15	23,25	62,78 *
PTSPACS 10125	10 / 12,5	23,25	62,78 *
PTSPACS 1530	15 / 30	44,50	120,15 *
PTSPACS 2025	20 / 25	44,50	120,15 *

COLOURS

	ON DEMAND
AC - Polished stainless st. AISI 304/1.4301-V2A	ACS - Brushed stainless st. AISI 304/1.4301-V2A

JOINT
GIPTSAC ..

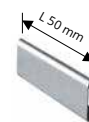

EXTERNAL CORNER (WELDED)
REPTSAC ..

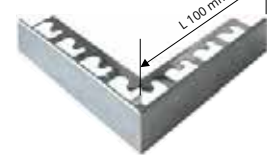

SUITABLE FOR USE IN CONTACT WITH FOODSTUFFS

PROTERMSTEP ALL

NATURAL AND ANODIZED SILVER
ALUMINIUM

PROTERMSTEP ALL is the new step cover profile made of natural and anodized aluminium. Designed to protect the edge of the step and to hide the joint between the tread and the step rise. The special notched shape in the upright stem provides it with excellent anchorage between floor/glue/profile.

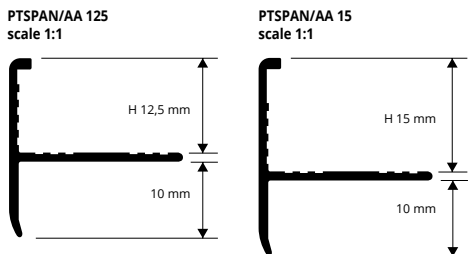
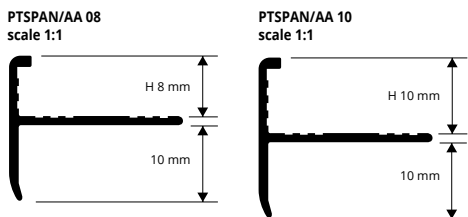

EXAMPLES AND INSTRUCTIONS FOR LAYING METHODS



NATURAL ALUMINIUM
bar length 2,7 lm - pack. 20 Pcs - 54 lm

Article	H mm	€/lm	€/Pc
PTSPAN 08	8	3,38	9,13
PTSPAN 10	10	3,50	9,45
PTSPAN 125	12,5	3,71	10,02
PTSPAN 15	15	4,03	10,88

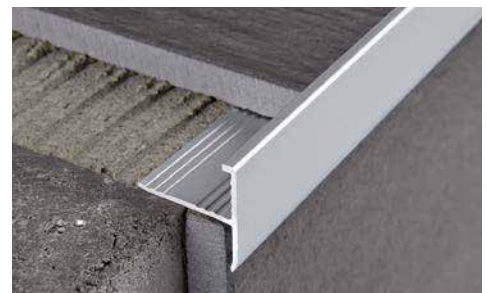

ANODIZED SILVER ALUMINIUM thermo packed
bar length 2,7 lm - pack. 20 Pcs - 54 lm

Article	H mm	€/lm	€/Pc
PTSPAA 08	8	4,46	12,04
PTSPAA 10	10	4,60	12,42
PTSPAA 125	12,5	4,80	12,96
PTSPAA 15	15	5,10	13,77

COLOURS

AN - Natural aluminium	AA - Anodized silver aluminium

1. Choose the PROTERMSTEP in the required width and colour according to the thickness of the tile (stairs). 2. First fix the riser part, placing it at the correct and final height. 3. Fill the empty spaces under the profile with the tile adhesive. 4. Apply the adhesive to the tread, lay the profile with the punched base fully sunk into the adhesive and align the profile so that its lip covers the edge of the riser tile. 5. Lay the tread tiles, aligning them so that they are flush with the upper and rear part of the profile and filling the internal part with adhesive.

* = Production on demand with minimum quantity of 100 pcs. Production delay 4/5 weeks. Price to be agreed

Prices are referred to whole packs, 10% increase for minimum orders of 10 pcs, 20% increase for orders of less than 10 pcs.

PROSIDE WALK is a perimeter profile in varnished aluminium, available in grey and anthracite colour. It is designed to protect the edges of the tiles and the screed on pavements. The profile is equipped with a punched flange that ensures its fixing to the support. The flange is also provided with small holes that allow the momentary fixing of the profile with nails. To reach a right connection between profile and the waterproofing system it's needed to use **PROBAND 150** with **PROBAND KOLL/AB**. The product is also available on request in **BENDABLE VERSION** and with a **SPECIAL SEASIDE PRE-TREATMENT** which increases its resistance to corrosion when installed at sea front environments.

PROSIDE WALK

VARNISHED / COATED ALUMINIUM



VARNISHED EMBOSSED ALUMINIUM

bar length 2,7 lm - pack. 20 Pcs - 54 lm

Article	h mm	H mm	L	€/lm	€/Pc
PSDWK 10AL...	10	45	80	20,21	54,57
PSDWK 125AL...	12,5	45	80	20,53	55,43
PSDWK 15AL...	15	45	80	20,83	56,24
PSDWK 20AL...	20	45	80	22,04	59,51

EMBOSSED COLOURS



A - Anthracite grey (no RAL) GF - Gray (7038) TF - Dark brown (8019)

EMBOSSED COLOURS ON DEMAND



BF - White (9010) C - Corten EF - Beige (1019)

EXTERNAL CORNERS - pack. 10 Pcs

Article	h mm	H mm	L	€/Pack
AEPSDWK 10AL.../10	10	45	80	217,71
AEPSDWK 125AL.../10	12,5	45	80	223,87
AEPSDWK 15AL.../10	15	45	80	236,30
AEPSDWK 20AL.../10	20	45	80	254,17

JOINTS - pack. 10 Pcs

Article	€/Pack
GINSDWK 10AL.../10	62,18
GINSDWK 125AL.../10	62,18
GINSDWK 15AL.../10	62,18
GINSDWK 20AL.../10	62,18

AEPSDWK external corner (welded)

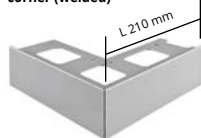

GINSDWK joint



PSDWK 10AL / 125AL / 15AL

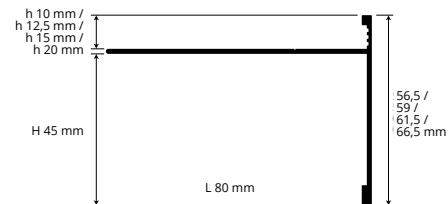

EXAMPLES AND INSTRUCTIONS FOR LAYING METHODS



1. Choose PROSIDE WALK according to the tile thickness and desired colour. 2. Waterproof with PROBAND 150 and PROBAND KOLL the front of the screed. 3. Fix the external corners with nails. 4. Cut PROSIDE WALK to the desired length and fix it with nails; connect it with the corners using the junction element. 5. Lay the tiles, leaving about 5 mm between tiles and profile. 6. Seal the space between tiles and profile with **PROBAND FIX (PRBFX)**. **PROFILE BENDING:** 1) Cut the anchoring flange into sections and engrave the metal close to the vertical side 2) bend the profile with the help of a template;

HOW TO REQUEST SEASIDE TREATMENT

When placing your order please add SD to the article's number

Example: PSDWK 10ALGF (seaside) = **PSDWK 10ALGFSD**
price for seaside treatment +50% on the gross price.

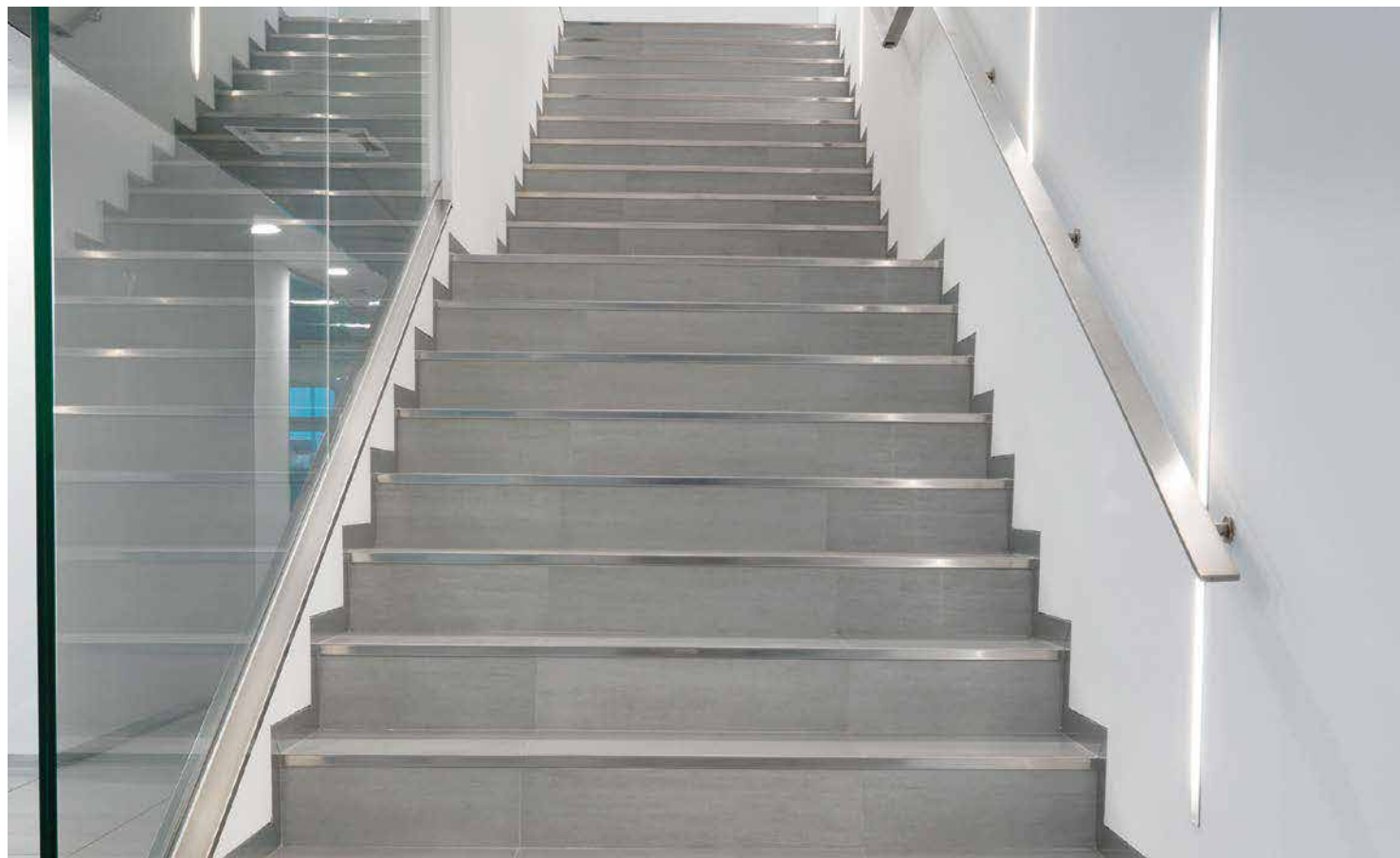

* = Production on demand with minimum quantity of 100 pcs. Production delay 4/5 weeks. Price to be agreed

Prices are referred to whole packs, 10% increase for minimum orders of 10 pcs, 20% increase for orders of less than 10 pcs.

PROSTAIR LED

ANODIZED SILVER ALUMINIUM
- FLAT - LED

PROSTAIR LED is an aluminium profile available in the silver anodized finishes, that can be fixed with adhesive or dowels to the step tread. It has a grooved non-slip 52,5mm wide horizontal surface and an integrated LED lighting system, placed on its 43,5mm high vertical side. The integrated LED system generates cold or warm light and is protected by a matt or transparent polycarbonate plate, provided with a special fixing system, that allows it to be removed any time maintenance on the lighting system should be required. Its design and to the range of finishes available, together with its easy installation make **PROSTAIR LED** an appreciated solution both in public and in residential spaces.

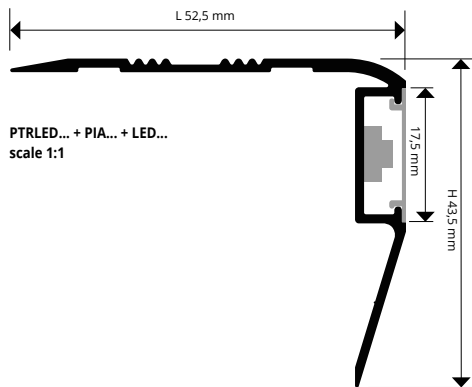

EXAMPLES AND INSTRUCTIONS FOR LAYING METHODS



1. Choose PROSTAIR LED depending on the desired finish, light effect and polycarbonate plate; 2. If you are using the version with adhesive, clean first the surface where the profile will be installed. Once the surface has dried, remove the protective film and install the profile, applying adequate pressure on it; 3. If you are using the punched version, place the profile on the step tread and mark the position of the profile holes on the step tread; 4. Drill the step tread and fasten the profile using plugs; 5. Connect the LED to the low tension power supply and install the polycarbonate plate.



ANODIZED SILVER ALUMINIUM
bar length 2,7 lm - pack. 20 Pcs - 54 lm
ADAPTOR LED, LED & FLAT NOT INCLUDED

Article	H x L mm	€/lm	€/Pc
PTRLEDAA 5040	43,5 X 52,5	24,26	65,50
PTRLEDAA 5040A	43,5 X 52,5	27,99	75,57
PTRLEDAA 5040F	43,5 X 52,5	26,11	70,50

"A" at the end of the product code = Item with adhesive
"F" at the end of the product code = Punched Item

ADHESIVE FLEXIBLE LED COIL
length 5 lm - pack. 1 ROLL

Article	€/lm	€/Pack.
LEDN	21,40	107,00
LEDF	21,40	107,00
LEDC	21,40	107,00

"N" at the end of the product code = neutral light
"F" at the end of the product code = cold light
"C" at the end of the product code = hot light

COLOURS



AA - Anodized silver alum.



POLYCARBONATE FLAT bar length 2,7 lm - pack. 20 Pc - 54 lm
(AL = transparent / AO = matt)

Article	€/lm	€/Pc
PIAL 17	4,91	13,26
PIAO 17	4,91	13,26

ENDCAPS- R / L - pack. 6 Pcs (3 R and 3 L)

Article	H x L mm	€/Pc	€/Pack.
TPTRLEDAA 5040/3	43,5 X 52,5		26,16



LED ADAPTOR AC/DC 75W - 12V (15 lm)

Article	€/Pc
ALL 7512	78,35

LED ADAPTOR AC/DC 25W - 12V (5 lm)

Article	€/Pc
ALL 2512	53,73

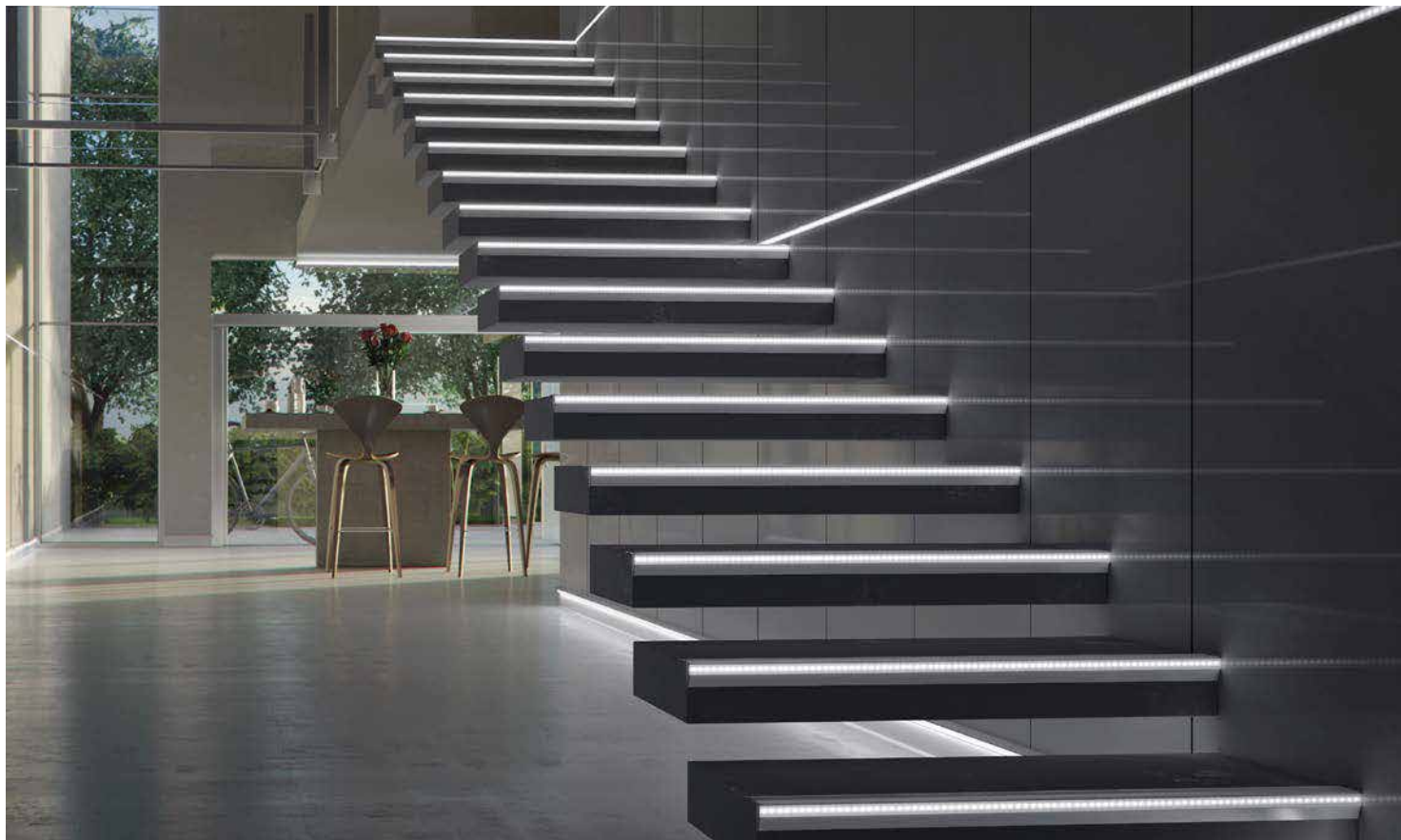



PROSTYLE

ROUNDED STEP NOSING
STAINLESS STEEL AISI 304/1.4301-V2A

PROSTYLE is a technical/decorative profile in stainless steel AISI 304/1.4301-V2A for ceramic tile/wood steps. Its particular rounded shape has been conceived to create the "torus" of the step, which is normally created with special pieces. Elegant profile for all public/private environments. In order to perfect placing and to look after details, external angles and closing caps are available.

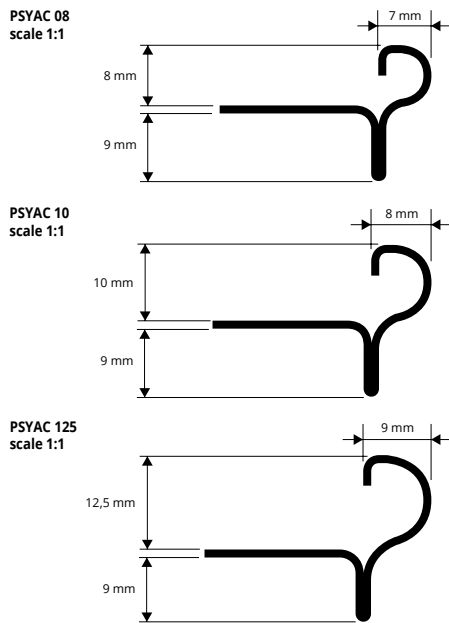

POLISHED STAINLESS ST. AISI 304/1.4301-V2A with protective film
bar length 2,7 lm - pack 20 Pcs - 54 lm - 10/10mm

Article	H mm	€/lm	€/Pc
PSYAC 08	8	15,59	42,09
PSYAC 10	10	16,08	43,42
PSYAC 125	12,5	16,88	45,58

COLOURS



AC - Polished stainless st.
AISI 304/1.4301-V2A

SUITABLE FOR USE IN CONTACT WITH FOODSTUFFS

VARNISHED PLASTIC STEEL EFFECT JOINT - pack 20 Pcs

Article	€/Pc	€/Pack.
RPSYAC 08/20	7,67	153,40
RPSYAC 10/20	7,67	153,40
RPSYAC 125/20	7,67	153,40



EXAMPLES AND INSTRUCTIONS FOR LAYING METHODS



1. Choose the PROSTYLE with suitable height for the thickness of the floor (stairs). 2. Apply the adhesive onto the area of application of the profile. 3. Lay and align the profile, cut to the necessary length, pressing the perforated flange into the adhesive. 4. Lay the tiles, aligning them so that the top edge of the profile is "flush" with the tile. 5. Fill the profile/tile area of contact with adhesive to prevent the accumulation of water in any voids.

STAINLESS ST. END CAPS H 8 - 10 - 12,5 mm - pack 20 Pcs

Article	€/Pc	€/Pack.
TPSYAC 08/20	3,71	74,20
TPSYAC 10/20	3,71	74,20
TPSYAC 125/20	3,71	74,20

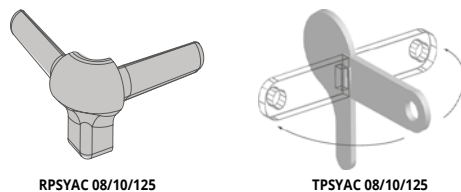

PROSTYLE

KNURLED, ROUNDED STEP NOSING
NATURAL, POLISHED AND CHROMED BRASS

PROSTYLE is a technical/decorative profile in natural brass, as well as with polished or chromed finish, for ceramic tile/wood steps. Its particular rounded shape has been conceived to create the "torus" of the step, which is normally created with special pieces. It is knurled on the top to make the profile non-slip. Elegant profile for all public/private environments. Shrink-wrapped profile with bar code.

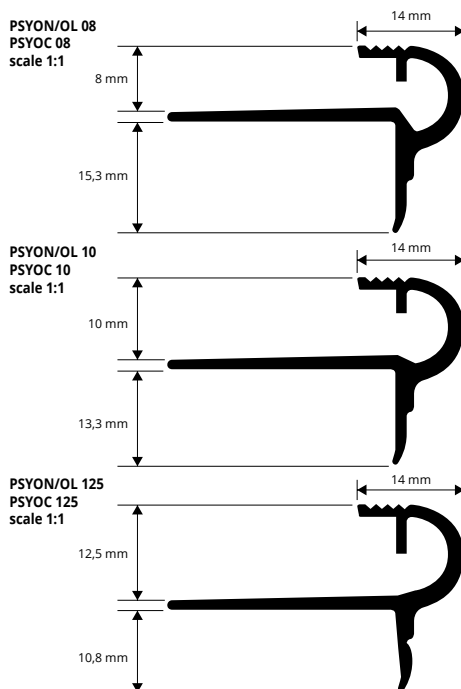

CHROMED BRASS thermo packed
bar length 2,7 lm - pack 10 Pcs - 27 lm

Article	H mm	€/lm	€/Pc
PSYOC 08	8	30,60	82,62 *
PSYOC 10	10	31,55	85,19 *
PSYOC 125	12,5	32,96	88,99 *

NATURAL BRASS thermo packed
bar length 2,7 lm - pack 10 Pcs - 27 lm

Article	H mm	€/lm	€/Pc
PSYON 08	8	21,59	58,29
PSYON 10	10	22,35	60,35
PSYON 125	12,5	24,14	65,18

VARNISHED PLASTIC JOINT - pack 20 Pcs

Article	€/Pack
RPSYOC 08-10-125/20	153,11 *
RPSYOL 08-10-125/20	153,11 *
RPSYON 08-10-125/20	153,11



POLISHED BRASS thermo packed
bar length 2,7 lm - pack 10 Pcs - 27 lm

Article	H mm	€/lm	€/Pc
PSYOL 08	8	26,31	26,31 *
PSYOL 10	10	27,07	27,07 *
PSYOL 125	12,5	28,49	28,49 *

BRASS CAPS H 8 - 10 - 12,5 mm - pack 20 Pcs

Article	€/Pack
TPSYOC 08-10-125/20	74,14 *
TPSYOL 08-10-125/20	74,14 *
TPSYON 08-10-125/20	74,14

COLOURS



* = Production on demand with minimum quantity of 100 pcs. Production delay 4/5 weeks. Price to be agreed

Prices are referred to whole packs, 10% increase for minimum orders of 10 pcs, 20% increase for orders of less than 10 pcs.

PROSTYLE is a technical/decorative profile for ceramic tile/wood steps made in gold-silver anodized aluminium. Its particular rounded shape has been conceived to create the "torus" of the step, which is normally created with special pieces. It is knurled on the top to make the profile non-slip. Elegant profile for all public/private environments. Shrink-wrapped profile with bar code.

PROSTYLE

KNURLED, ROUNDED STEP NOSING
GOLD AND SILVER ANODIZED ALUMINIUM

EXAMPLES AND INSTRUCTIONS FOR LAYING METHODS

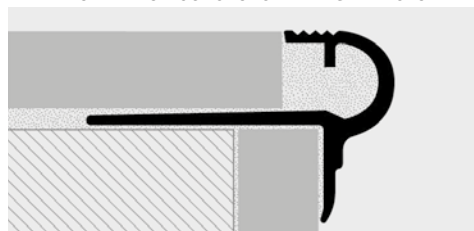

1. Choose the PROSTYLE in the required width and colour according to the thickness of the tile. 2. First fix the riser part, placing it at the correct and final height. 3. Fill the empty spaces under the profile with the tile adhesive. 4. Apply the adhesive to the tread, lay the profile with the punched base fully sunk into the adhesive and align the profile so that its vertical part covers the edge of the riser tile. 5. Lay the tread tiles, aligning them so that they are flush with the upper and rear part of the profile and filling the internal part with adhesive. Oxidation marks in the polished/natural brass range may be easily removed with specific chemical products (Sidel-Smac).



ANODIZED SILVER ALUMINIUM thermo packed
bar length 2,7 lm - pack. 20 Pcs - 54 lm

Article	H mm	€/lm	€/Pc
PSYAA 08	8	8,87	23,95
PSYAA 10	10	9,33	25,19
PSYAA 125	12,5	9,96	26,89

ANODIZED GOLD ALUMINIUM thermo packed
bar length 2,7 lm - pack. 20 Pcs - 54 lm

Article	H mm	€/lm	€/Pc
PSYAO 08	8	8,87	23,95
PSYAO 10	10	9,33	25,19
PSYAO 125	12,5	9,96	26,89

ALUMINIUM CAPS H 8 - 10 - 12,5 mm - pack. 20 Pcs

Article	€/Pack
TPSYAO 08/20	74,14
TPSY... 08/20	74,14
TPSY... 10/20	74,14
TPSY... 125/20	74,14

Available: AA - AO.
The code of the selected colour must be added to the article code.
E.g.: TPSY... 08 (chosen colour polished brass) TPSYOL 08.

COLOURS

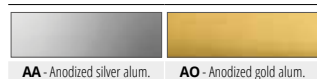

VARNISHED PLASTIC JOINT - pack. 20 Pcs

Article	€/Pack
RPSYAO 08/20	153,11
RPSY... 08-10-125/20	153,11

Universal, suitable for three profile heights
Available: AA - AO.
The code of the selected colour must be added to the article code.
E.g.: RPSY... 08 (chosen colour polished brass) RPSYOL 08

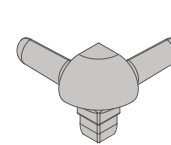
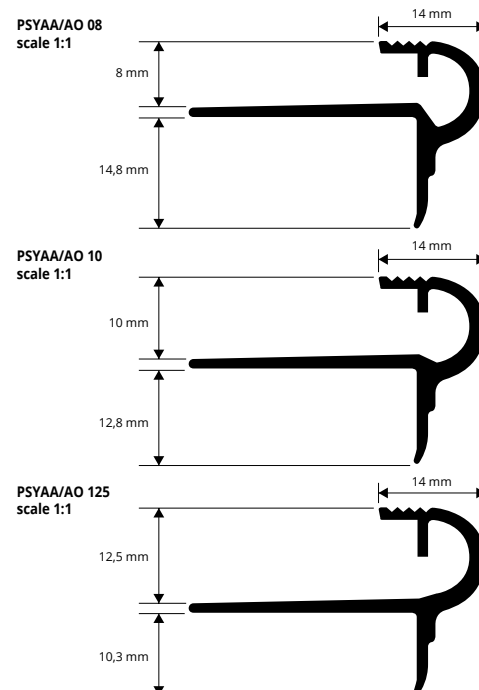

RPSY... 08-10-125



TPSY... 08/10/125

PROSTEP INS is a non-slip profile in aluminium that allows to connect the rise and the tread in case of stairs covered with wooden or laminate flooring. The profile has to be laid together with rise and tread. It is equipped with a punched flange that guarantees its fixing. PROSTEP INS in anodized aluminium is suitable for any stair covered with wooden flooring.

PROSTEP INS

ANODIZED SILVER ALUMINIUM



ANODIZED SILVER ALUMINIUM
bar length 2,7 lm - pack. 40 Pcs - 108 lm

Article	H mm	€/lm	€/Pc
PTSAA 105	10,5	6,52	17,60
PTSAA 16	16	7,02	18,95

COLOURS



EXAMPLES AND INSTRUCTIONS FOR LAYING METHODS



1. Choose "PROSTEP INS" according to the thickness of the tile. 2. Cut "PROSTEP INS" to the desired length. 3. Lay the wood or laminate on the step rise and apply adhesive on the area of the step tread, where the profile will be laid. 4. Lay the profile on the step tread, aligning it with the edge of the rise covering. 5. Lay the wood or laminate on the tread of the step taking care to insert it into the cavity.

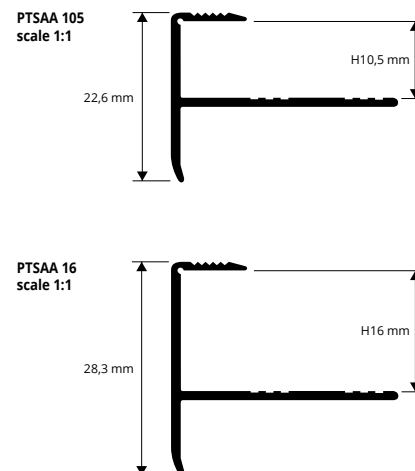

stair nosing profiles

* = Production on demand with minimum quantity of 100 pcs. Production delay 4/5 weeks. Price to be agreed

Prices are referred to whole packs, 10% increase for minimum orders of 10 pcs, 20% increase for orders of less than 10 pcs.

PROSTAIR WOOD

NATURAL OAK
+ ALUMINIUM BASE

PROSTAIR WOOD is a step nosing profile in real oak with aluminium base. Its rounded "torus/convex" shape makes a perfect and elegant nosing for stairs and steps in ceramic-tile-terracotta-wood for indoor and outdoor environments. Attractive. **PROSTAIR WOOD** may be treated and painted subsequently at the time of laying, according to the finishes chosen for the staircase.

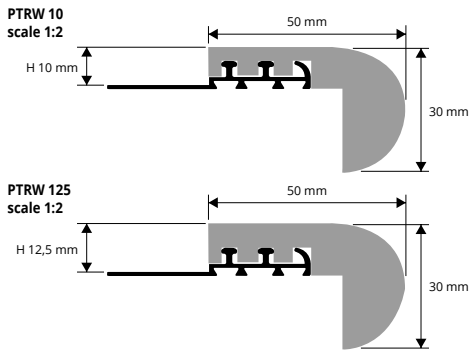

EXAMPLES AND INSTRUCTIONS FOR LAYING METHODS

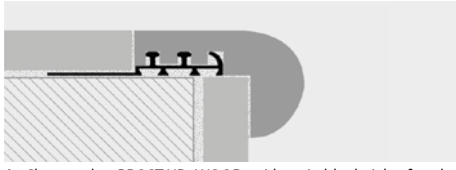

1. Choose the PROSTAIR WOOD with suitable height for the thickness of the covering of the step or staircase. 2. Apply the adhesive onto the area of application of the profile. 3. Lay and align the profile, cut to the necessary length, pressing the perforated flange into the adhesive. 4. Lay the step covering, aligning it so that the top edge of the profile is flush with the covering. 5. Fill the profile/covering area of contact with adhesive to prevent any infiltration.



NATURAL OAK + ALUMINIUM BASE
bar length 2,7 lm - pack. 10 Pcs - 27 lm

Article	H mm	€/lm	€/Pc
PTRW 10	10	39,98	107,95 *
PTRW 125	12,5	42,41	114,51 *

H 15 mm on demand

COLOURS

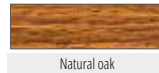

NATURAL OAK + ALUMINIUM BASE
bar length 1,20 lm - pack. 10 Pcs - 12 lm

Article	H mm	€/lm
PTRW 1020	10	58,28 *
PTRW 12520	12,5	59,88 *

NATURAL OAK + ALUMINIUM BASE
bar length 1,80 lm - pack. 10 Pcs - 18 lm

Article	H mm	€/lm
PTRW 1080	10	88,73 *
PTRW 12580	12,5	89,85 *

ITEMS SUPPLIED ALREADY ASSEMBLED
Treat the wood appropriately with paint or oil.

PROSTAIR WOOD Z

KNURLED NATURAL OAK
+ ALUMINIUM BASE

PROSTAIR WOOD Z is a step nosing profile in real oak with aluminium base. The rounded shape of the "knurled convex" torus with non-slip surface makes a perfect and elegant nosing for stairs and steps in ceramic-tile-terracotta-wood for indoor and outdoor environments. Attractive. **PROSTAIR WOOD Z** may be treated and painted subsequently at the time of laying, according to the finishes chosen for the staircase.

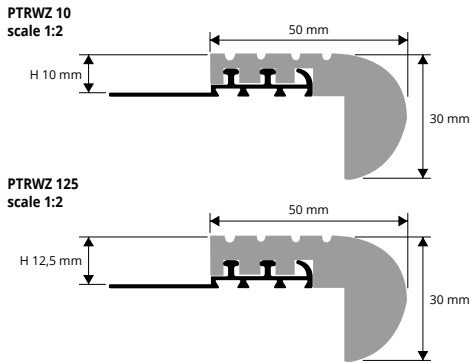

EXAMPLES AND INSTRUCTIONS FOR LAYING METHODS

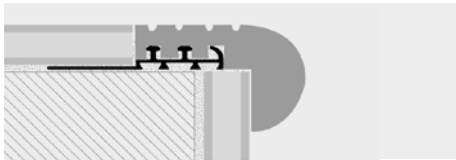

1. Choose the PROSTAIR WOOD Z with suitable height for the thickness of the covering of the step or staircase. 2. Apply the adhesive onto the area of application of the profile. 3. Lay and align the profile, cut to the necessary length, pressing the perforated flange into the adhesive. 4. Lay the step covering, aligning it so that the top edge of the profile is flush with the covering. 5. Fill the profile/covering area of contact with adhesive to prevent any infiltration.



NATURAL OAK + ALUMINIUM BASE
bar length 2,7 lm - pack. 10 Pcs - 27 lm

Article	H mm	€/lm	€/Pc
PTRWZ 10	10	50,96	137,59 *
PTRWZ 125	12,5	52,37	141,40 *

H 15 mm on demand

COLOURS



NATURAL OAK + ALUMINIUM BASE
bar length 1,20 lm - pack. 10 Pcs - 12 lm

Article	H mm	€/lm
PTRWZ 1020	10	61,13 *
PTRWZ 12520	12,5	62,85 *

NATURAL OAK + ALUMINIUM BASE
bar length 1,80 lm - pack. 10 Pcs - 18 lm

Article	H mm	€/lm
PTRWZ 1080	10	91,72 *
PTRWZ 12580	12,5	94,27 *

ITEMS SUPPLIED ALREADY ASSEMBLED
Treat the wood appropriately with paint or oil.

PROSTEP WOOD is a step nosing profile in real oak with aluminium base. Its 90° shape makes a perfect and elegant nosing for modern stairs and steps in ceramic-tile-terracotta-wood for indoor and outdoor environments. Attractive.

PROSTEP WOOD may be treated and painted subsequently at the time of laying, according to the finishes chosen for the staircase.

PROSTEP WOOD

NATURAL OAK
+ ALUMINIUM BASE

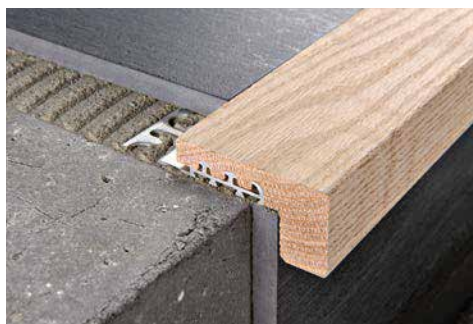

NATURAL OAK + ALUMINIUM BASE
bar length 2,7 lm - pack. 10 Pcs - 27 lm

Article	H mm	€/lm	€/Pc
PTPW 10	10	45,41	122,61
PTPW 125	12,5	46,62	125,87

NATURAL OAK + ALUMINIUM BASE
bar length 1,20 lm - pack. 10 Pcs - 12 lm

Article	H mm	€/Pc
PTPW 1020	10	46,61
PTPW 12520	12,5	48,27

NATURAL OAK + ALUMINIUM BASE
bar length 1,80 lm - pack. 10 Pcs - 18 lm

Article	H mm	€/Pc
PTPW 1080	10	69,81
PTPW 12580	12,5	72,37

COLOURS

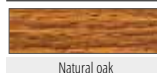

ITEMS SUPPLIED ALREADY ASSEMBLED
Treat the wood appropriately with paint or oil.

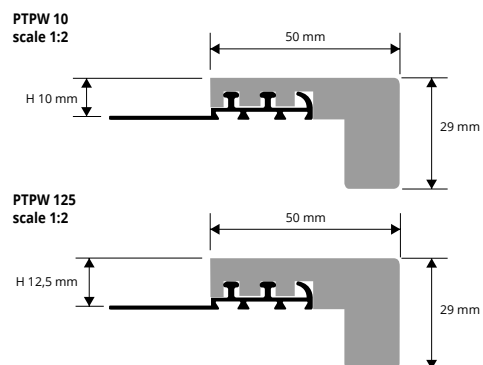

EXAMPLES AND INSTRUCTIONS FOR LAYING METHODS

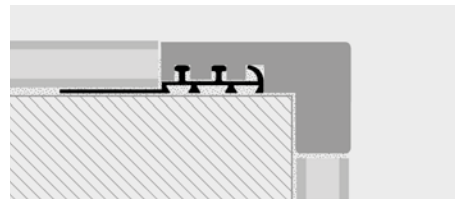

1. Choose the PROSTEP WOOD with suitable height for the thickness of the covering of the step or staircase. 2. Apply the adhesive onto the area of application of the profile. 3. Lay and align the profile, cut to the necessary length, pressing the perforated flange into the adhesive. 4. Lay the step covering, aligning it so that the top edge of the profile is "flush" with the covering. 5. Fill the profile/covering area of contact with adhesive to prevent any infiltration.

PROSTYLE WOOD is a step nosing profile in real oak with aluminium base. Its rounded "torus/fret" shape makes a perfect and elegant nosing for stairs and steps in ceramic-tile-terracotta-wood for indoor and outdoor environments. Attractive.

PROSTYLE WOOD may be treated and painted subsequently at the time of laying, according to the finishes chosen for the staircase.

PROSTYLE WOOD

NATURAL OAK
+ ALUMINIUM BASE



NATURAL OAK + ALUMINIUM BASE
bar length 2,7 lm - pack. 10 Pcs - 27 lm

Article	H mm	€/lm	€/Pc
PSYW 10	10	44,06	118,96
PSYW 125	12,5	45,34	122,42

NATURAL OAK + ALUMINIUM BASE
bar length 1,20 lm - pack. 10 Pcs - 12 lm

Article	H mm	€/Pc
PSYW 1020	10	58,28
PSYW 12520	12,5	59,88

NATURAL OAK + ALUMINIUM BASE
bar length 1,80 lm - pack. 10 Pcs - 18 lm

Article	H mm	€/Pc
PSYW 1080	10	87,39
PSYW 12580	12,5	92,59

COLOURS



ITEMS SUPPLIED ALREADY ASSEMBLED
Treat the wood appropriately with paint or oil.

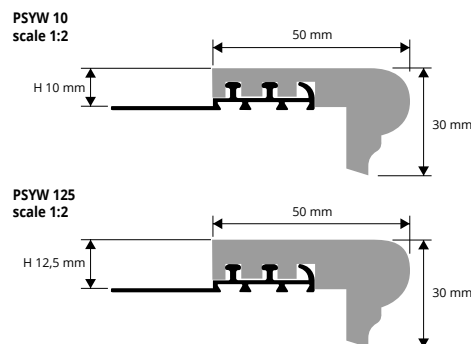

EXAMPLES AND INSTRUCTIONS FOR LAYING METHODS

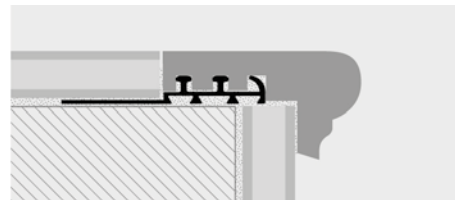

1. Choose the PROSTYLE WOOD with suitable height for the thickness of the covering of the step or staircase. 2. Apply the adhesive onto the area of application of the profile. 3. Lay and align the profile, cut to the necessary length, pressing the perforated flange into the adhesive. 4. Lay the step covering, aligning it so that the top edge of the profile is "flush" with the covering. 5. Fill the profile/covering area of contact with adhesive to prevent any infiltration.

* = Production on demand with minimum quantity of 100 pcs. Production delay 4/5 weeks. Price to be agreed

Prices are referred to whole packs, 10% increase for minimum orders of 10 pcs, 20% increase for orders of less than 10 pcs.

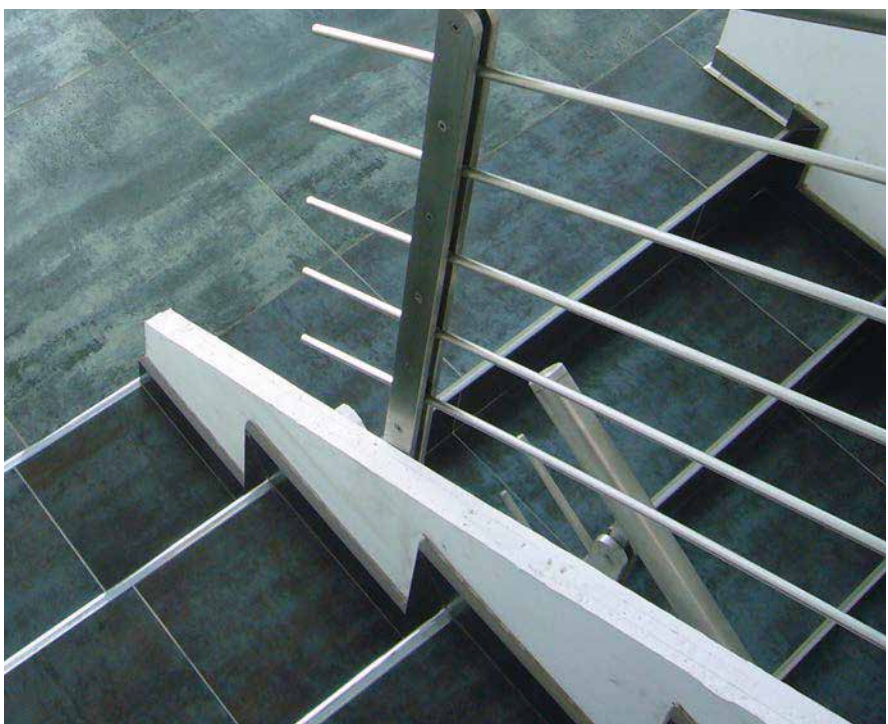

TUBE and **ACCESSORIES** for runners and stair-carpet guides, available in the finishes in polished painted brass, polished gold aluminium and polished chrome aluminium.

TUBES and ACCESSORIES

GOLD AND CHROME POLISHED ALUMINIUM
POLISHED VARNISHED BRASS



BLISTER KIT - 2 TUBES AND 4 TUBE PLUGS - POLISHED BRASS COATED
length tube 0,8 lm - pack. 60 Pcs

Article	Ø mm	€/Pc
TCTOL 118S	11	21,30
TCTOL 138S	13	23,13

BLISTER KIT - 2 TUBES AND 4 TUBE PLUGS - POLISHED BRASS COATED
length tube 0,9 lm - pack. 60 Pcs

Article	Ø mm	€/Pc
TCTOL 119S	11	23,29
TCTOL 139S	13	25,27

BLISTER KIT - 2 TUBES AND 4 TUBE PLUGS - POLISHED BRASS COATED
length tube 1 lm - pack. 60 Pcs

Article	Ø mm	€/Pc
TCTOL 1110S	11	25,27
TCTOL 1310S	13	27,39

BLISTER KIT - 2 TUBES AND 4 TUBE PLUGS - POLISHED ALUM.
length tube 0,8 lm - pack. 60 Pcs

Article	Ø mm	€/Pc
TCTBO 128S	12	15,53
TCTBC 128S	12	18,22

BLISTER KIT - 2 TUBES AND 4 TUBE PLUGS - POLISHED ALUM.
length tube 0,9 lm - pack. 60 Pcs

Article	Ø mm	€/Pc
TCTBO 129S	12	16,92
TCTBC 129S	12	19,58

BLISTER KIT - 2 TUBES AND 4 TUBE PLUGS - POLISHED ALUM.
length tube 1 lm - pack. 60 Pcs

Article	Ø mm	€/Pc
TCTBO 1210S	12	18,27
TCTBC 1210S	12	20,95

TCTOL 11/13S

TCTBO 12S

TCTBC 12S

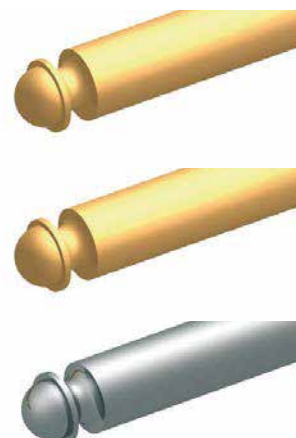

tube and accessories for stairs

Varnished polished brass is not suitable for places subject to heavy foot-traffic and / or abrasion.

COLOURS

BO - Polished gold alum.	BC - Polished chrome alum.	OL - Polished brass coated
--------------------------	----------------------------	----------------------------

TUBE for runners and stair-carpet guides

GOLD AND CHROME POLISHED ALUMINIUM, POLISHED VARNISHED BRASS

POLISHED BRASS COATED
bar length 2 lm - pack. 40 Pcs - 80 lm

Article	Ø mm	€/ml	€/Pc
TGSOL 112	11	16,81	33,62
TGSOL 132	13	19,69	39,38

For different size bars, contact the sales office.

POLISHED ALUMINIUM
bar length 2 lm - pack. 40 Pcs - 80 lm

Article	Ø mm	€/ml	€/Pc
TGSBO 122	12	6,58	13,16
TGSBC 122	12	6,58	13,16

TGSOL 11/13

TGSBO 12

TGSBC 12



TUBE PLUGS/END CAPS for tube

POLISHED BRASS AND CHROMED BRASS

POLISHED BRASS AND CHROMED BRASS - pack. 60 Pcs

Article	Ø mm	€/Pack.
TETOL 11	11	40,57
TETOC 12	12	105,78
TETOL 12	12	47,82
TETOL 13	13	55,06

TETOL 11
TETOL 12
TETOL 13

TETOC 12



SUPPORT / EYELET for tube with screw

POLISHED BRASS AND CHROMED BRASS

POLISHED BRASS AND CHROMED BRASS - pack. 20 Pcs

Article	Ø mm	€/Pack.
SOOL 12	12	44,68
SOOC 12	12	75,35
SOOL 14	14	47,33

SOOL 12
SOOL 14

SOOC 12



HINGE SUPPORT for tube

POLISHED BRASS

POLISHED BRASS - pack. 20 Pcs

Article	Ø mm	€/Pack.
SCOL 11	11	148,28
SCOL 13	13	157,22

Articles without bar code.
For bar code add the letter "C" after the article code. E.g.: SCOL 11C and add € 0,40 x Pc (+ 0,20 x lm) to the gross price.
For cutting to required length 1 lm + 5 % x lm.

SCOL 11
SCOL 13



* = Production on demand with minimum quantity of 200 pcs. Production delay 4/5 weeks. Price to be agreed

Prices are referred to whole packs, 10% increase for minimum orders of 10 pcs, 20% increase for orders of less than 10 pcs.

PROWALK ACC

POLISHED STAINLESS STEEL AISI 304/1.4301-V2A
PUNCHED OR SELF ADHESIVE

PROWALK ACC is steps protecting steel profile for existing scales. Its superior side level is crimped in order to increase its adhesion. Available in version or with holes either with adhesive. Available sizes: 30 x 10, 30 x 20, and 30 x 30 mm. All profiles are protected with protective film. It's ideal for the edges protection and screening as well as of the corner between the rising and the tread which is the point of the greatest strain.

STAIR nosing for existing steps

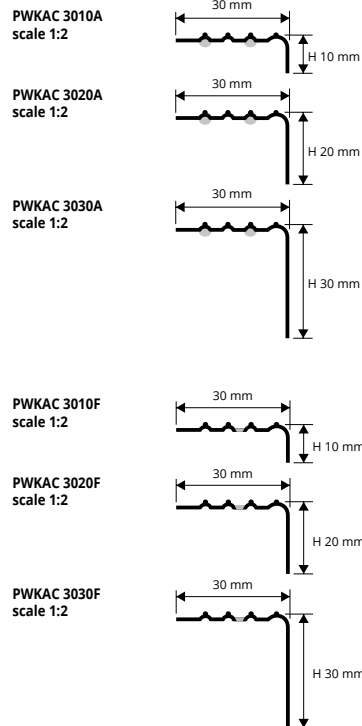

POLISHED STAINLESS STEEL AISI 304/1.4301-V2A with adhesive
thermo packed - bar length 2,7 lm - pack. 20 Pcs - 54 lm - 10/10mm

Article	L x H mm	€/lm	€/Pc
PWKAC 3010A	30 X 10	18,46	49,84
PWKAC 3020A	30 X 20	20,95	56,57
PWKAC 3030A	30 X 30	23,51	63,48

INSTRUCTIONS FOR LAYING METHODS

Adhesive version

1. Choose the suitable profile and cut it to the necessary length.
2. Degrease, wash and clean the solid surface thoroughly. 3. Remove the protective paper from the adhesive. 4. Lay the profile by applying pressure evenly over the whole surface without using a hammer.

Punched version

1. Choose the suitable profile and cut it to the necessary length.
2. Mark the position of the holes using the existing holes in the profile as reference. 3. Insert the screw anchors into the drilled holes. 4. Fix the profile using flathead screws suitable for the relative slots in the profile.



POLISHED STAINLESS STEEL AISI 304/1.4301-V2A punched - with protective film - bar length 2,7 lm - pack. 20 Pcs - 54 lm - 10/10mm

Article	L x H mm	€/lm	€/Pc
PWKAC 3010F	30 X 10	16,54	44,66
PWKAC 3020F	30 X 20	19,03	51,38
PWKAC 3030F	30 X 30	21,59	58,29

COLOURS



ON DEMAND HAND-BRUSHED
STAINLESS STEEL
(Price to be agreed.
Production delay 4/5 weeks)

SUITABLE FOR USE IN CONTACT WITH FOODSTUFFS

PROEND

GOLD, SILVER AND BRONZE ANOD. ALUMINIUM
WITH/ WITHOUT ADHESIVE AND PUNCHED

PROEND is a step nosing profile in anodized aluminium with silver-gold-bronze finish, available with self-adhesive backing or punched. Ideal for protecting existing steps and with knurled flat surface, it guarantees excellent safety features to prevent accidents in public and private environments.

PROEND ensures a perfect finish, covering laying defects and protecting the edge. Easy to lay with the self-adhesive backing ensuring perfect adherence to the step or using screws and screw anchors in the punched version.

STAIR nosing for existing steps

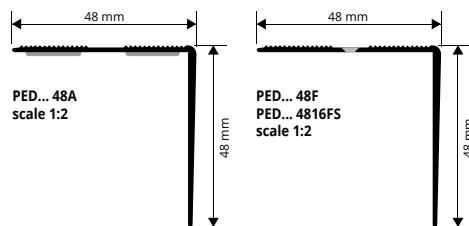

EXAMPLES AND INSTRUCTIONS FOR LAYING METHODS

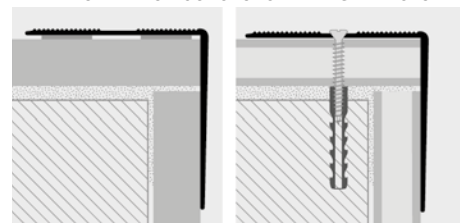

Adhesive version

1. Choose the suitable profile and cut it to the necessary length.
2. Degrease, wash and clean the solid surface thoroughly.
3. Remove the protective paper from the adhesive. 4. Lay the profile by applying pressure evenly over the whole surface without using a hammer.

Punched version

1. Choose the suitable profile and cut it to the necessary length.
2. Mark the position of the holes using the existing holes in the profile as reference. 3. Insert the screw anchors into the drilled holes. 4. Fix the profile using flathead screws suitable for the relative slots in the profile.



ANOD. ALUMINIUM with and without adhesive thermo packed
bar length 2,7 lm - pack. 10 Pcs - 27 lm

Article	H x L mm	€/lm	€/Pc
PED... 48A	48 X 48	10,42	28,13
PED... 48	48 X 48	8,96	24,19

"A" at the end of the product code = Item with adhesive

On demand bar length 3 lm with minimum quantity of 200 pcs.
Production delay 4/5 weeks. Price to be agreed.

COLOURS



AA - Anodized silver alum. AO - Anodized gold alum. AB - Anodized bronze alum.



ANODIZED ALUMINIUM punched thermo packed
bar length 2,7 lm - pack. 10 Pcs - 27 lm

Article	H x L mm	€/lm	€/Pc
PED... 48F	48 X 48	8,95	24,16

ANOD. ALU. punched with screws and screw anchors
thermo packed - bar length 1,65 lm - pack. 20 Pcs

Article	H x L mm	€/lm	€/Pc
PED... 4816FS	48 X 48	18,26	

Available in the colours: AA - AO - AB. The code of the selected colour must be added to the article code.
E.g.: PED... 48A (chosen colour anodized gold) PEDAO 48A.

PROWALK is a step nosing profile in polished brass and anodized aluminium for existing steps. The upper part is knurled to increase slip and slide resistance and is applied after laying. Available with holes or without holes. Available in the widths 22 x 22 and 30 x 30 mm. All the profiles are shrink-wrapped. Ideal for protecting and shielding the edges and corner between riser and tread, which are the areas subjected to most stress.

PROWALK

POLISHED BRASS and ANODIZED ALUMINIUM
ADHESIVE and PUNCHED



KNURLED POLISHED BRASS with adhesive thermo packed
bar length 2,7 lm - pack. 15 Pcs - 40,5 lm

Article	H x L mm	€/lm	€/Pc
PWKOL 22A	22 X 22	23,12	62,42
PWKOL 30A	30 X 30	29,77	80,38

KNURLED POLISHED BRASS punched thermo packed
bar length 2,7 lm - pack. 15 Pcs - 40,5 lm

Article	H x L mm	€/lm	€/Pc
PWKOL 22F	22 X 22	20,56	55,51
PWKOL 30F	30 X 30	27,22	73,49

KNURLED POLISHED BRASS without holes thermo packed
bar length 2,7 lm - pack. 15 Pcs - 40,5 lm

Article	H x L mm	€/lm	€/Pc
PWKOL 22	22 X 22	20,31	54,84
PWKOL 30	30 X 30	26,68	72,04

KNURLED POLISHED BRASS with adhesive thermo packed - bar length 0,90 lm - pack. 20 Pcs

Article	H x L mm	€/lm	€/Pc
PWKOL 229AS	22 X 22		20,43
PWKOL 309AS	30 X 30		29,82

KNURLED POLI. BRASS punched with screws and screw anchors thermo packed - bar length 0,90 lm - pack. 20 Pcs

Article	H x L mm	€/lm	€/Pc
PWKOL 309FS	30 X 30		24,14

COLOURS



OL - Polished brass

KNURLED ANODIZED ALUMINIUM with adhesive thermo packed
bar length 2,7 lm - pack. 20 Pcs - 54 lm

Article	H x L mm	€/lm	€/Pc
PWK... 22A	22 X 22	7,97	21,52
PWK... 30A	30 X 30	11,54	31,16

KNURLED ANODIZED ALUMINIUM punched thermo packed
bar length 2,7 lm - pack. 20 Pcs - 54 lm

Article	H x L mm	€/lm	€/Pc
PWK... 22F	22 X 22	6,01	16,23
PWK... 30F	30 X 30	8,73	23,57

KNURLED ANODIZED ALUM. WITHOUT HOLES thermo packed
bar length 2,7 lm - pack. 20 Pcs - 54 lm

Article	H x L mm	€/lm	€/Pc
PWK... 22	22 X 22	5,81	15,69
PWK... 30	30 X 30	8,43	22,76

KNURLED ANODIZED ALUMINIUM with adhesive thermo packed - bar length 0,90 lm - pack. 20 Pcs

Article	H x L mm	€/lm	€/Pc
PWK... 229AS	22 X 22		8,67
PWK... 309AS	30 X 30		11,83

KNURLED ANOD. ALU. punched with screws and screw anchors thermo packed - bar length 0,90 lm - pack. 20 Pcs

Article	H x L mm	€/lm	€/Pc
PWK... 229FS	22 X 22		7,08
PWK... 309FS	30 X 30		9,64

Available in the colours: AO - AA - AB (AT, CH and SB available on demand with a minimum quantity order of 100 pcs). The code of the selected colour must be added to the article code. E.g.: PWK... 22A (chosen colour anodized gold) PWKAO 22A.

COLOURS

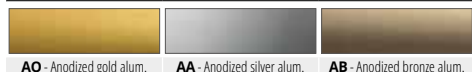

AO - Anodized gold alum.

AA - Anodized silver alum.

AB - Anodized bronze alum.

ON DEMAND MINIMUM QUANTITY 100 PCS for color and height

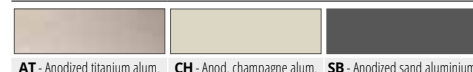

AT - Anodized titanium alum.

CH - Anod. champagne alum.

SB - Anodized sand aluminium

PWK... 22A
PWK... 229AS
scale 1:1

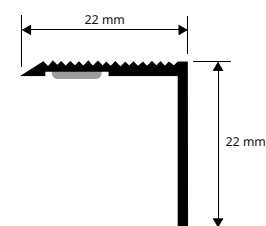

PWK... 30A
PWK... 309AS
scale 1:1

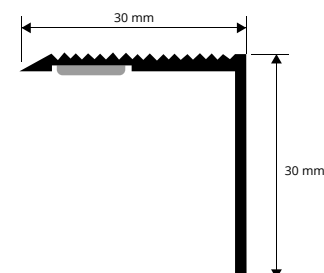

PWK... 22F
PWK... 229FS
scale 1:1

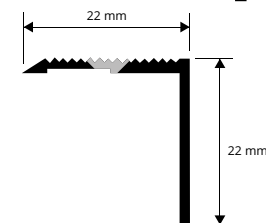

PWK... 30F
PWK... 309FS
scale 1:1

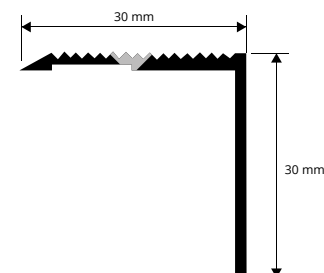

stair nosing for existing steps

EXAMPLES AND INSTRUCTIONS FOR LAYING METHODS

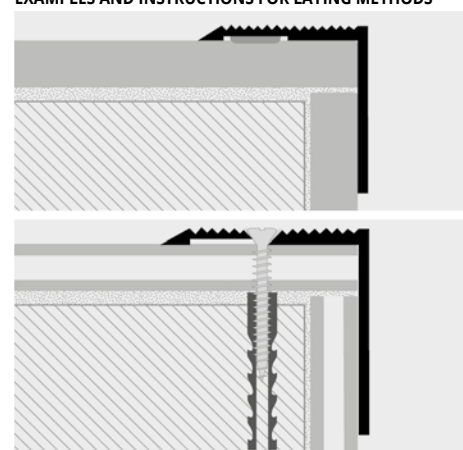

Adhesive version

1. Choose the suitable profile and cut it to the necessary length.
2. Degrease, wash and clean the solid surface thoroughly.
3. Remove the protective paper from the adhesive.
4. Lay the profile by applying pressure evenly over the whole surface without using a hammer.

Punched version

1. Choose the suitable profile and cut it to the necessary length.
2. Mark the position of the holes using the existing holes in the profile as reference.
3. Insert the screw anchors into the drilled holes.
4. Fix the profile using flathead screws suitable for the relative slots in the profile.

* = Production on demand with minimum quantity of 100 pcs. Production delay 4/5 weeks. Price to be agreed

Prices are referred to whole packs, 10% increase for minimum orders of 10 pcs, 20% increase for orders of less than 10 pcs.

PROWALK 2510 PROWALK 2520

ALUMINIUM 30 WOOD FINISHES AND 6
ANODIZED FINISHES PUNCHED OR SELF ADHESIVE

STAIR nosing for existing steps

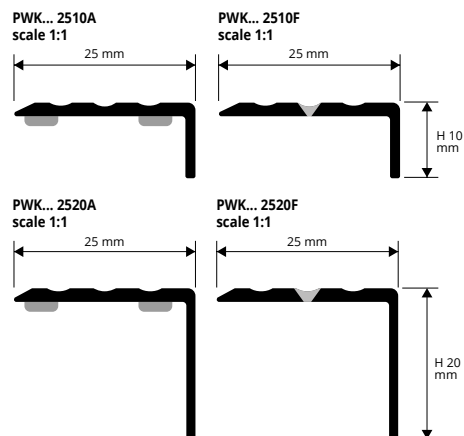

EXAMPLES AND INSTRUCTIONS FOR LAYING METHODS

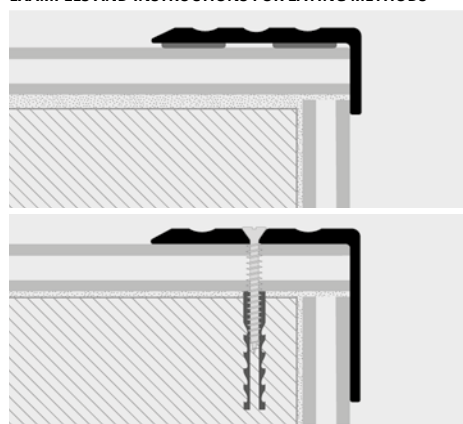

Adhesive version

1. Choose the suitable profile and cut it to the necessary length.
2. Degrease, wash and clean the solid surface thoroughly.
3. Remove the protective paper from the adhesive.
4. Lay the profile by applying pressure evenly over the whole surface without using a hammer.

Punched version

1. Choose the suitable profile and cut it to the necessary length.
2. Mark the position of the holes using the existing holes in the profile as reference.
3. Insert the screw anchors into the drilled holes.
4. Fix the profile using flathead screws suitable for the relative slots in the profile.



ANODIZED ALUMINIUM with adhesive thermo packed
bar length 2,7 lm - pack. 40 Pcs - 108 lm

Article	L x H mm	€/lm	€/Pc
PWK... 2510A	25 X 10	5,94	16,04
PWK... 2520A	25 X 20	6,52	17,60

ANODIZED ALUMINIUM with adhesive thermo packed - bar length 0,90 lm - pack. 20 Pcs

Article	L x H mm	€/lm	€/Pc
PWK... 25109AS	25 X 10		6,39



SELF
PACK



ANODIZED ALUMINIUM punched thermo packed
bar length 2,7 lm - pack. 40 Pcs - 108 lm

Article	L x H mm	€/lm	€/Pc
PWK... 2510F	25 X 10	4,46	12,04
PWK... 2520F	25 X 20	5,12	13,82

ANODIZED ALUM. punched, screws and screw anchors thermo packed - bar length 0,90 lm - pack. 20 Pcs

Article	L x H mm	€/lm	€/Pc
PWK... 25109FS	25 X 10		5,37



SELF
PACK

ANODIZED ALUM. punched, screws and screw anchors thermo packed - bar length 1,35 lm - pack. 20 Pcs

Article	L x H mm	€/lm	€/Pc
PWK... 251013FS	25 X 10		7,79



SELF
PACK

Available in the finishes: AO - AA - AB (AT, CH e SB on demand with a minimum order of 100 pcs).

The code of the selected finish must be added to the article code. E.g.: PWK... 2510A (chosen finish anodized silver) PWKAA 2510A.

ALUMINIUM WOODEN FINISHES with adhesive thermo packed
bar length 2,7 lm - pack. 40 Pcs - 108 lm

Article	L x H mm	€/lm	€/Pc
PWK... 2510A	25 X 10	9,89	26,70
PWK... 2520A	25 X 20	11,89	32,10

Available on demand in the colours: 04W - 05W - 07W - 09W - 13W - 18W - 21W - 25W - 29W - 30W - 31W - 32W - 33W - 34W - 35W - 36W - 37W - 38W - 39W - 41W - 42W - 44W - 45W - 46W - 48W - 49W - 53W - 54W - 55W - 65W - 73W - 75W with a minimum quantity order of 100 pcs.

The code of the selected colour must be added to the article code. E.g.: PWK... 2510A (chosen finish dark beech) PWK04 2510A.

COLOURS

ANODIZED		
AO - Anodized gold alum.	AA - Anodized silver alum.	AB - Anodized bronze alum.

ON DEMAND MINIMUM QUANTITY 100 PCS for color and height

(For a precise assessment of colours request the wooden finishes sample range)

ANODIZED								
AT - Anodized titanium alum.	CH - Anod. champagne alum.	SB - Anodized sand aluminium						
04W - Dark beech	05W - Light oak (strip)	07W - Light cherry (strip)	09W - Red walnut (merbau-apple-walnut)	13W - Indonesian teak	18W - Light zerbano	21W - Oak powder	25W - Bleached fir	29W - White oak
30W - Grey oak	31W - Victoria oak	32W - Pink oak	33W - Sawed oak	34W - Havana oak	35W - Edinburgh oak	36W - American oak	37W - Carvi oak	38W - Queens oak
39W - Grey elm	41W - Ice oak	42W - Grace oak	44W - Honey oak	45W - Marocco oak	46W - Black decap'	48W - Cork oak	49W - Sand oak	53W
54W	55W	65W - Tripoli	73W - Bangkok	75W - Liotard				

On demand it is possible to produce samples of wood finishes. Contact the office for negotiation, small amounts, timing and costs.

* = Production on demand with minimum quantity of 100 pcs. Production delay 4/5 weeks. Price to be agreed

Prices are referred to whole packs, 10% increase for minimum orders of 10 pcs, 20% increase for orders of less than 10 pcs.

PROEND INS 75 is a step nosing profile in anodized aluminium with interchangeable rubber insert: the upper part is knurled to increase slip and slide resistance and is applied after laying. Available anodized with gold, bronze or silver finish and with adhesive or punched.

PROEND INS 75 ensures a perfect finish, covering laying defects and protecting the edge. Easy to lay with the self-adhesive backing ensuring perfect adherence to the step or with screws and screw anchors in the punched version.

PROEND INS 75

GOLD, SILVER AND BRONZE ANOD. ALUMINIUM
ADHESIVE AND PUNCHED

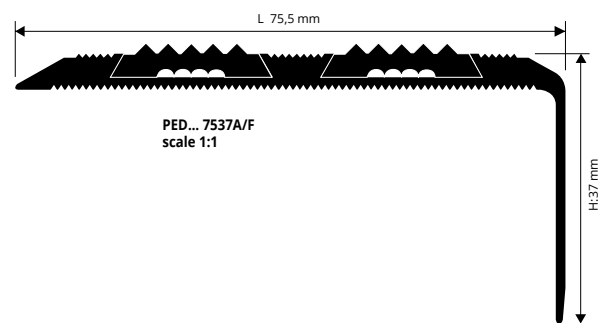

stair nosing for existing steps

ANODIZED ALUMINIUM with DOUBLE INSERT
thermo packed - with adhesive

bar length 2,7 lm - pack. 10 Pcs - 27 lm

Article	H x L mm	€/lm	€/Pc
PED... 7537A	37 X 75,5	25,70	69,39

ANODIZED ALUMINIUM with DOUBLE INSERT
thermo packed - punched

bar length 2,7 lm - pack. 10 Pcs - 27 lm

Article	H x L mm	€/lm	€/Pc
PED... 7537F	37 X 75,5	21,98	59,35

On demand bar length 3 lm with minimum quantity of 200 pcs.
Production delay 4/5 weeks. Price to be agreed.

Available in the finishes: AA - AO - AB.

The code of the selected finish must be added to the article code.
E.g.: PED... 7537A (chosen finish anodized gold) PEDAO 7537A.

EXAMPLES AND INSTRUCTIONS FOR LAYING METHODS

Adhesive version

1. Choose the suitable profile and cut it to the necessary length.
2. Degrease, wash and clean the solid surface thoroughly. 3. Remove the protective paper from the adhesive. 4. Lay the profile by applying pressure evenly over the whole surface without using a hammer.

Punched version

1. Choose the suitable profile and cut it to the necessary length.
2. Mark the position of the holes using the existing holes in the profile as reference. 3. Insert the screw anchors into the drilled holes. 4. Fix the profile using flathead screws suitable for the relative slots in the profile.

COLOURS

AA - Anodized silver alum.	AO - Anodized gold alum.	AB - Anodized bronze alum.

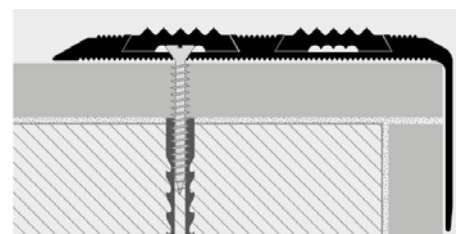
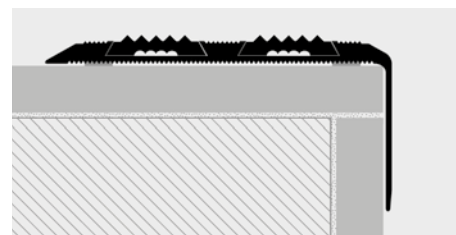

PROEND INS is a step nosing profile in anodized aluminium with interchangeable rubber insert: the upper part is knurled to increase slip and slide resistance and is applied after laying. Available anodized with gold, bronze or silver finish and with adhesive or punched.

PROEND INS ensures a perfect finish, covering laying defects and protecting the edge. Easy to lay with the self-adhesive backing ensuring perfect adherence to the step or with screws and screw anchors in the punched version.

PROEND INS

GOLD, SILVER AND BRONZE ANOD. ALUMINIUM
ADHESIVE AND PUNCHED

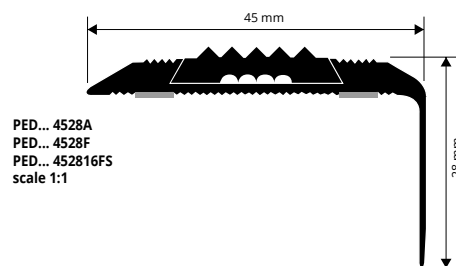

ANODIZED ALUM. with adhesive WITH INSERT thermo packed
bar length 2,7 lm - pack. 20 Pcs - 54 lm

Article	H x L mm	€/lm	€/Pc
PED... 4528A	28 X 45	16,29	43,98

On demand bar length 3 lm with minimum quantity of 200 pcs. Production delay 4/5 weeks. Price to be agreed.

AN. ALUM. punched WITH INSERT, screws and screw anchors
thermo packed - bar length 1,65 lm - pack. 20 Pcs



Article	H x L mm	€/lm	€/Pc
PED... 452816FS	28 X 45		29,58

Available in the finishes: AA - AO - AB.

The code of the selected colour must be added to the article code.
E.g.: PED... 4528A (chosen finish anodized gold) PEDAO 4528A.

ANODIZED ALUM. punched WITH INSERT thermo packed
bar length 2,7 lm - pack. 20 Pcs - 54 lm

Article	H x L mm	€/lm	€/Pc
PED... 4528F	28 X 45	11,75	31,73

COLOURS

AA - Anodized silver alum.	AO - Anodized gold alum.	AB - Anodized bronze alum.

EXAMPLES OF LAYING

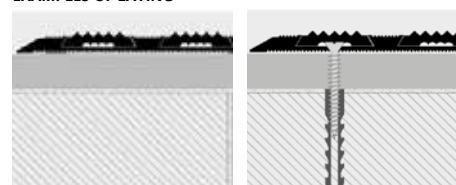

For instructions see the product above

BLACK INTERCHANGEABLE INSERT

VINYL RESIN / RUBBER

VINYL RESIN / RUBBER

bar length 2,7 lm - pack. 20 Pcs - 54 lm

Article	€/lm	€/Pc
IIN 12	2,10	5,67

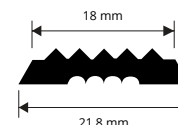

* = Production on demand with minimum quantity of 100 pcs. Production delay 4/5 weeks. Price to be agreed

Prices are referred to whole packs, 10% increase for minimum orders of 10 pcs, 20% increase for orders of less than 10 pcs.

PROEND GRIP 70

SILVER, GOLD AND BRONZE ANOD. ALUMINIUM
+ NON-SLIP INSERT ADHESIVE AND PUNCHED

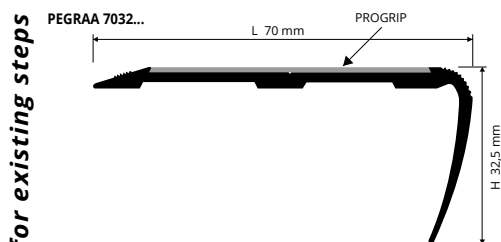

EXAMPLES AND INSTRUCTIONS FOR LAYING METHODS

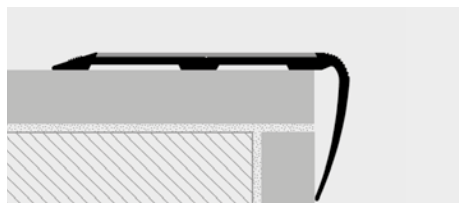

Adhesive version

1. Choose the suitable profile and cut it to the necessary length.
2. Degrease, wash and clean the solid surface thoroughly.
3. Remove the protective paper from the adhesive. 4. Lay the profile by applying pressure evenly over the whole surface without using a hammer.

Punched version

1. Choose the suitable profile and cut it to the necessary length.
2. Mark the position of the holes using the existing holes in the profile as reference. 3. Insert the screw anchors into the drilled holes. 4. Fix the profile using flathead screws suitable for the relative slots in the profile.

PROEND GRIP 70 is a non-slip step nosing profile in anodized aluminium with adhesive non-slip 50mm thick insert in black carborundum to be fitted in the relative groove in the top of the profile upon completion of laying. The profile may be laid with fixing screws hidden afterwards by the adhesive carborundum, or with silicone and/or adhesive to be applied on the bottom of the profile, which is designed to ensure an excellent grip. It is made in anodized aluminium with silver, gold or bronze finish with anodizing coat of approx. 15/20 micron.



SILVER, GOLD AND BRONZE ANODIZED ALUM. with adhesive
thermo packed - bar length 2,7 lm - pack. 20 Pcs - 54 lm

Article	H x L mm	€/lm	€/Pc
PEGR... 7032A	32,5 X 70	18,29	49,38

SILVER, GOLD AND BRONZE ANODIZED ALUM. punched
thermo packed - bar length 2,7 lm - pack. 20 Pcs - 54 lm

Article	H x L mm	€/lm	€/Pc
PEGR... 7032F	32,5 X 70	14,97	40,42

Available in the finishes: AA - AO - AB.
The code of the selected finish must be added to the article code.
E.g.: PEGR... 7032A (chosen finish anodized gold) PEGRAO. 7032A.

COLOURS

AA - Anodized silver alum.	AO - Anodized gold alum.	AB - Anodized bronze alum.
----------------------------	--------------------------	----------------------------

On demand bar length 3 lm with minimum quantity of 200 pcs. Production delay 4/5 weeks. Price to be agreed.

The adhesive carborundum strip (PROGRIP) is not included with the profile.
For PEGR... 7032... order PGR... 50 (Specify the chosen colour).

PROEND 5050

ANODIZED SILVER ALUMINIUM
+ NON-SLIP INSERT ADHESIVE AND PUNCHED

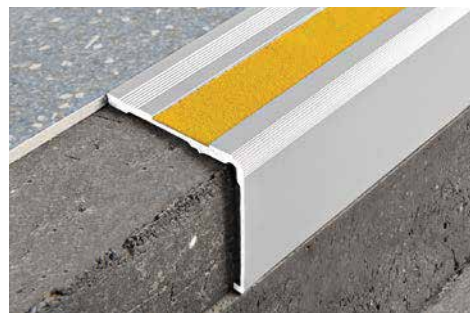
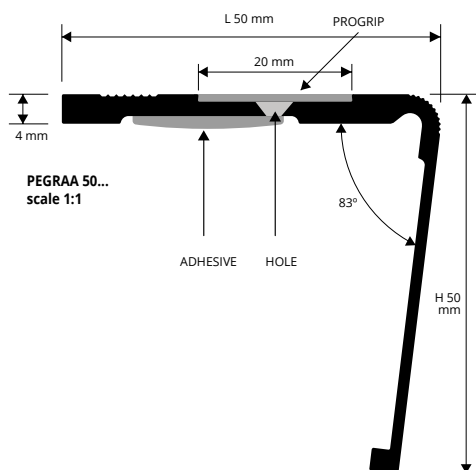

ANODIZED SILVER ALUMINIUM punched / with adhesive
bar length 2,7 lm - pack. 20 Pcs - 54 lm

Article	HxL mm	€/lm	€/Pc
PEGRAA 50F	50 X 50	12,81	34,59 *
PEGRAA 50A	50 X 50	15,30	41,31 *

COLOURS

AA - Anodized silver alum.

On demand bar length 3 lm with minimum quantity of 200 pcs. Production delay 4/5 weeks. Price to be agreed.

The adhesive carborundum strip (PROGRIP) is not included with the profile.
For PEGRAA 50... order PGR... 20 (Specify the chosen colour).

INSTRUCTIONS FOR LAYING METHODS

Adhesive version

1. Cut PROEND 5050 to the desired length; 2. Remove all the remains of oil, grease and dirt from the surface where the profile will be laid; 3. When the surface is perfectly dry, remove the protective film and press the profile exerting the appropriate pressure; 4. Apply the non-slip strip in carborundum in the desired colour.

Punched version

1. Cut PROEND 5050 to the correct size; 2. Mark on the support the position of the holes present on the profile; 3. Drill holes in the bracket with a 5 mm diameter bit and insert the 5 x 25 mm rawlplugs; 4. Align the profiles over the holes and screw it to support; 5. Apply the non-slip carborundum adhesive insert in the desired color.

EXAMPLES OF LAYING

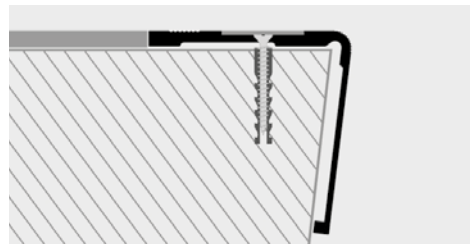
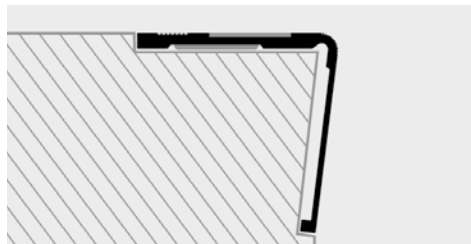

* = Production on demand with minimum quantity of 100 pcs. Production delay 4/5 weeks. Price to be agreed

Prices are referred to whole packs, 10% increase for minimum orders of 10 pcs, 20% increase for orders of less than 10 pcs.

PROEND GRIP is a non-slip step nosing profile in anodized aluminium with adhesive non-slip 20mm thick insert in black carborundum to be fitted in the relative groove in the top of the profile upon completion of laying. The profile may be laid with fixing screws hidden afterwards by the adhesive carborundum, or with silicone and/or adhesive to be applied on the bottom of the profile, which is designed to ensure an excellent grip. It is made in anodized aluminium with silver, gold or bronze finish with anodizing coat of approx. 15/20 micron.

PROEND GRIP

SILVER, GOLD AND BRONZE ANOD. ALUMINIUM
+ NON-SLIP INSERT ADHESIVE AND PUNCHED



ANODIZED SILVER, GOLD AND BRONZE ALUM. with adhesive thermo packed - bar length 2,7 lm - pack. 20 Pcs - 54 lm

Article	H x L mm	€/lm	€/Pc
PEGR... 5230A	30 X 52	15,44	41,69

On demand bar length 3 lm with minimum quantity of 200 pcs. Production delay 4/5 weeks. Price to be agreed.

ANODIZED SILVER, GOLD AND BRONZE ALUM.
with adhesive - thermo packed
bar length 1,66 lm - pack. 20 Pcs

Article	H x L mm	€/lm	€/Pc
PEGR... 523016AS	30 X 52	30,53	*

Available in the finishes: AA - AO - AB.

The code of the selected finish must be added to the article code. E.g.: PEGR... 523016AS (chosen finish anodized silver) PEGRAA 523016AS.

The adhesive carborundum strip (PROGRIP) is not included with the profile.
For PEGR... 5230... order PGR... 20 (Specify the chosen colour).

COLOURS

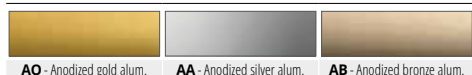

* = Production on demand with minimum quantity of 100 pcs. Production delay 4/5 weeks. Price to be agreed

PROGRIP is a self-adhesive product in carborundum consisting of a plastic film plus abrasive granules with high resistance to wear. It is normally used to guarantee safety on steps in public and private environments, as required by accident-prevention laws. Available in various colours and widths to meet all technical and aesthetic requirements. It is advisable to apply 2 strips on each step, rounding off the ends.

PEGR... 5230A/F
scale 1:1

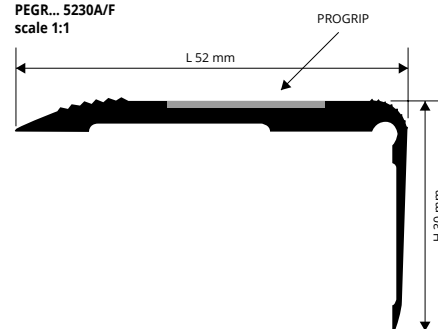

EXAMPLES AND INSTRUCTIONS FOR LAYING METHODS

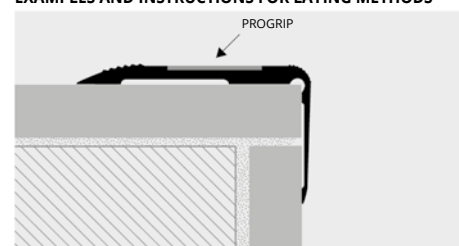

1. Choose the suitable profile for covering the edge of the step.
 2. Clean the surface on which the profile is to be laid, ensuring that it is grease-free and dry. Do not apply the strips at temperatures below 15°.
 3. Remove the protective paper from the adhesive and lay correctly by applying pressure evenly over the whole profile without using a hammer.
- If the punched PROEND GRIP has been chosen, screw the profile to the step and apply the adhesive carborundum to hide the screws.

stair nosing for existing steps

STEPS

PROGRIP

ADHESIVE CARBORUNDUM - 6 COLOURS

ADHESIVE CARBORUNDUM NON-SLIP STRIP for STEPS

rolls length 18,2 lm

Article	Width mm	€/lm	€/Roll
PGRN 20	20	1,92	34,94
PGRB 20	20	3,39	61,70
PGRT 20	20	1,92	34,94
PGRG 20	20	3,81	69,34
PGRY 20	20	3,81	69,34
PGRM 20	20	2,21	40,22
PGRN 25	25	2,55	46,41
PGRB 25	25	3,83	69,71
PGRT 25	25	2,55	46,41
PGRG 25	25	4,34	78,99
PGRY 25	25	4,21	76,62
PGRM 25	25	2,93	53,33
PGRN 50	50	5,24	95,37
PGRB 50	50	7,79	141,78
PGRT 50	50	5,24	95,37
PGRG 50	50	8,62	156,88
PGRY 50	50	8,56	155,79
PGRM 50	50	5,81	105,74

ADHESIVE NON-SLIP STRIP for STEPS - rolls length 18,2 lm

Article	Width mm	€/lm	€/Roll
PGRGN 20	20	1,93	35,13
PGRGN 25	25	2,59	47,14
PGRGN 50	50	5,31	96,64



COLOURS

N - Black	B - White	T - Transparent
G - Gray	Y - Yellow	M - Brown
GN - Yellow/Black	The PGRT (transparent) are not suitable for outside use.	



non-slip strip for steps

LAYING INSTRUCTIONS

1. Thoroughly clean and degrease the surface of application.
2. Round the ends of the strips.
3. Remove the protective paper from the adhesive and lay the PROGRIP using a roller.
4. Do not apply the strips at temperatures below 15°, otherwise heat the strips and the step.
5. When necessary clean away impurities with a brush and preserve the PROGRIP.
6. When laying on tiles, cut and round the corners of the strips on the inner part of the tile.
7. Carefully seal the outer edges of the strips to prevent water infiltration.

© = News 2021

* = Production on demand with minimum quantity of 10 rolls. Production delay 4/5 weeks. Price to be agreed

Prices are referred to whole packs, 10% increase for minimum orders of 10 pcs, 20% increase for orders of less than 10 pcs.